

ADDENDUM NO. 3

December 5, 2023

Creekside Middle School & West Clay Elementary School Site Renovations
3525 W. 126th Street
3495 W. 126th Street
Carmel, IN 46032

TO: ALL BIDDERS OF RECORD

This Addendum forms a part of and modifies the Bidding Requirements, Contract Forms, Contract Conditions, the Specifications and the Drawings dated November 10, 2023, by Fanning Howey Associates. Acknowledge receipt of the Addendum in the space provided on the Bid Form. Failure to do so may subject the Bidder to disqualification.

This Addendum consists of Pages ADD 3-1 and attached Fanning Howey Addendum No. 2 Revised Drawing Sheet: G1.01.

CREEKSIDE MIDDLE SCHOOL SITE RENOVATION

3525 W 126TH ST.
CARMEL, IN 46032

WEST CLAY ELEMENTARY SCHOOL SITE RENOVATION

3495 W 126TH ST.
CARMEL, IN 46032

CARMEL CLAY
SCHOOL DISTRICT



ARCHITECT



317-848-0966 WWW.FHAI.COM
350 EAST NEW YORK ST., SUITE 300
INDIANAPOLIS, IN 46204

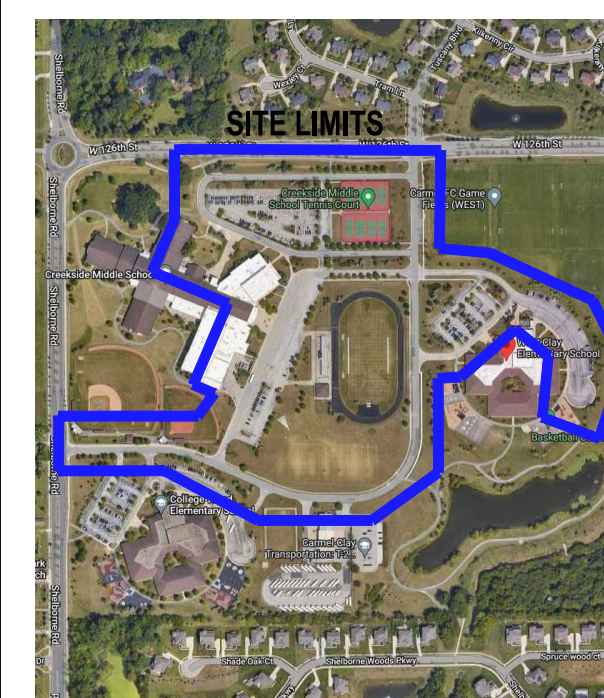

CONSTRUCTION DOCUMENTS



PROJECT MANAGER: EPB
DRAWN BY: KNB
PROJECT NUMBER: 222074.00
PROJECT ISSUE DATE: 11/10/2023

REV. NO.	DESCRIPTION	DATE
2	ADDENDUM #2	10/05/23

WEST ASPHALT PAVEMENT
PLAN

G1.01

PLAN KEYNOTES / LEGEND

- EXISTING ASPHALT SPEED BUMPS TO REMAIN. CONTRACTOR IS TO SITE VERIFY EXISTING CONDITIONS PRIOR TO THE START OF CONSTRUCTION AND PROTECT DURING CONSTRUCTION.
- MILL EXISTING SURFACE 1.5" WITH PUT BACK OF 2" NEW SURFACE COURSE ASPHALT WITH CONTRACTORS TO WEDGE NEW SURFACING FLUSH WITH ALL EXISTING SURFACES. SEE DETAIL 7, SHT G4.00
- MILL EXISTING PAVT FULL DEPTH. PROVIDE NEW 3" INTERMEDIATE COURSE ASPHALT WITH 2" OF SURFACE COURSE ASPHALT OVER EXISTING COMPACTED STONE BASE COURSE. SEE DETAIL 7, SHT G4.00
- NEW PAVT TO EXISTING PAVT. SEE DETAIL 8, SHT G4.00
- PROVIDE NEW PAVT MARKINGS TO MATCH EXISTING CONDITIONS. CONTRACTOR IS TO SITE VERIFY EXISTING CONDITIONS PRIOR TO THE START OF CONSTRUCTION. ALL EXISTING DIRECTIONAL ARROWS, FIRE LANE, STOP BARS, ACCESSIBLE PARKING, SPEED BUMPS, AND PARKING STALL MARKINGS TO BE RE-INSTALLED AFTER PAVING. SEE DETAILS 9, 10, AND 11, SHT G4.00
- EXISTING PAVT TO REMAIN. PROTECT DURING CONSTRUCTION.
- ASPHALT SPEED BUMPS TO BE REMOVED DURING DEMOLITION. AFTER MILLING PROVIDE NEW ASPHALT SPEED BUMPS AND SPEED BUMP PAINT MARKINGS TO MATCH EXISTING CONDITION AND LOCATION. CONTRACTOR IS TO SITE VERIFY EXISTING CONDITIONS PRIOR TO THE START OF CONSTRUCTION.
- SAWCUT PAVT
- CLEAN, CRACK-FILL EXISTING ASPHALT, AND SEAL COAT EXISTING ASPHALT

GENERAL NOTES

- THE CONTRACTOR SHALL WALK THE SITE PRIOR TO BID TO BE FULLY FAMILIAR WITH THE EXTENT OF REMOVAL ITEMS. THE CONTRACTOR IS RESPONSIBLE FOR ALL REMOVALS NECESSARY TO COMPLETE CONSTRUCTION. QUESTIONS REGARDING ITEMS TO BE REMOVED SHALL BE DIRECTED TO THE ARCHITECT.
- CONTRACTOR SHALL APPLY AND RECEIVE ALL PERMITS NECESSARY TO COMPLETE WORK WITHIN PUBLIC RIGHT-OF-WAYS. PROVIDE PROPER BARRICADES FOR WALKS AND STREETS ACCORDING TO INDIANA MANUAL OF UNIFORM TRAFFIC CONTROL DEVICES.
- PROTECT ALL TREES AND SHRUBS NOT SCHEDULED FOR REMOVAL. MINIMIZE EQUIPMENT OPERATION WITHIN THE ORANGE FENCE AT THE EXISTING TREE DRIPLINE/ROOT ZONES. DO NOT STORE, STOCKPILE, OR PARK WITHIN THE DRIPLINE/ROOT ZONE OF ANY EXISTING VEGETATION. HOLD NECESSARY DISTURBANCE TO A MINIMUM.
- MATERIALS AND STRUCTURES SHOWN FOR REMOVAL SHALL BE REMOVED IN THEIR ENTIRETY LEAVING ONLY NATURAL SOILS.
- IN THE EVENT THAT ANY STRUCTURES OR HISTORICAL ELEMENTS ARE DISCOVERED DURING CONSTRUCTION OPERATIONS, THESE ITEMS SHALL BE BROUGHT TO THE ATTENTION OF THE CONSTRUCTION MANAGER PRIOR TO PROCEEDING WITH THAT PORTION OF THE WORK.
- IN THE EVENT THAT ANY HAZARDOUS MATERIALS ARE DISCOVERED DURING CONSTRUCTION OPERATIONS, THESE ITEMS SHALL BE BROUGHT TO THE ATTENTION OF THE CONSTRUCTION MANAGER PRIOR TO PROCEEDING WITH THAT PORTION OF THE WORK.
- ANY ITEM THAT IS TO REMAIN THAT IS DAMAGED DURING CONSTRUCTION SHALL BE REPLACED AT NO COST TO THE OWNER. THIS INCLUDES, BUT IS NOT LIMITED TO, ALL PAVEMENTS (CONCRETE, ASPHALT), VEGETATION (TREES, SHRUBS, LAWNS), BUILDINGS (ALL STRUCTURES), UTILITIES (ABOVE AND BELOW GROUND), PLAY EQUIPMENT OR OTHER PERMANENT IMPROVEMENTS.

PAVING TAKE OFF LEGEND

- 1. 120,102 SQ. FT.
- 2. 244,175 SQ. FT.
- 3. 95,981 SQ. FT.

SEE G1.02: EAST ASPHALT PAVEMENT PLAN

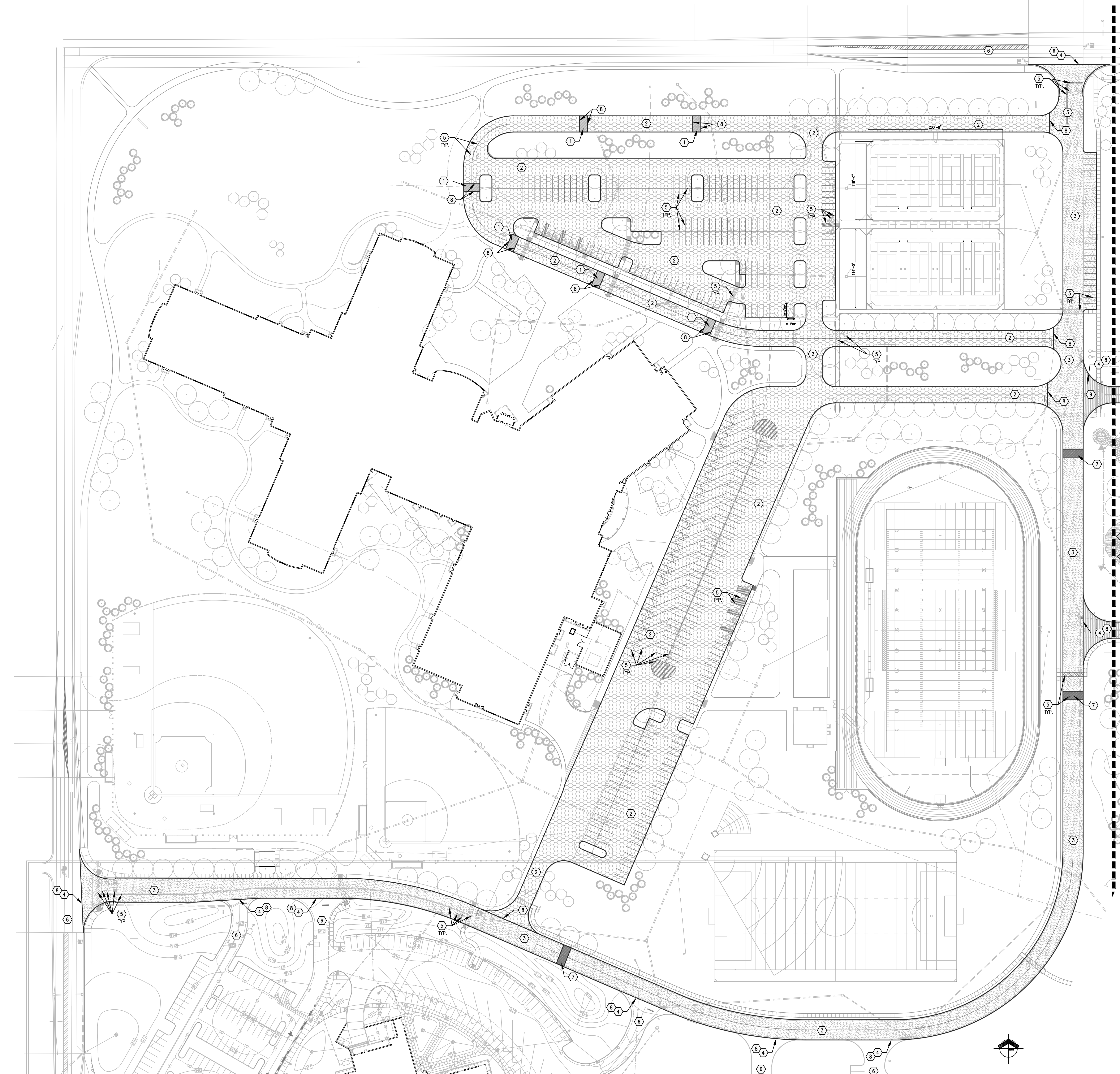

WEST ASPHALT PAVEMENT PLAN

0 30' 60' 120'
SCALE: 1" = 60'



CAUTION !!
THE LOCATION OF ALL EXISTING UNDERGROUND UTILITIES SHOWN ON THIS PLAN ARE BASED UPON RECORD DRAWINGS, FIELD SURVEY, AND OTHER AVAILABLE INFORMATION. CONTRACTOR SHALL VERIFY THE LOCATION AND DEPTH OF ALL UTILITIES PRIOR TO ANY CONSTRUCTION. CONTRACTOR SHALL BE RESPONSIBLE FOR ANY DAMAGE TO UTILITIES DURING CONSTRUCTION.

LOCATIONS GIVEN ARE APPROXIMATE AND ARE TO BE SITE VERIFIED PRIOR TO THE START OF CONSTRUCTION. ALL CONCRETE AND ASPHALT PAVING NOT NOTED FOR WORK IS TO REMAIN - PROTECT DURING CONSTRUCTION TYP