

**ADDENDUM
NO. 1**

July 31, 2024

Kalamazoo Public Schools – Winchell Elementary School Classroom Addition
2316 Winchell Avenue
Kalamazoo, MI 49008

TO: ALL BIDDERS OF RECORD

This Addendum forms a part of and modifies the Bidding Requirements, Contract Forms, Contract Conditions, the Specifications and the Drawings dated May 17, 2024, by TowerPinkster. Acknowledge receipt of the Addendum in the space provided on the Bid Form. Failure to do so may subject the Bidder to disqualification.

This Addendum consists of Pages ADD 1-1 through ADD 1-3.

A. SPECIFICATION SECTION 00 00 20 – TABLE OF CONTENTS

Add

1. Section 00 6324 - BIM TRANSFER WAIVER
2. Section 00 6325 - SUBSTITUTION DURING CONSTRUCTION REQUEST FORM

B. SPECIFICATION SECTION 01 12 00 – MULTIPLE CONTRACT SUMMARY

Paragraph 3.03 BID CATEGORIES

B. BID CATEGORY NO. 02 – CONCRETE

Add the following Specification

Section	07 92 00	Joint Sealants
---------	----------	----------------

C. BID CATEGORY NO. 03 – MASONRY

Add the following Specification

Section 07 92 00 Joint Sealants

D. BID CATEGORY NO. 04 – STRUCTURAL STEEL

Add the following Specification

Section 07 92 00 Joint Sealants

F. BID CATEGORY NO. 05 – GENERAL TRADES

Add the following Clarification:

1. General Trades shall be responsible for providing, installing, maintaining, and removal of ALL floor protection and temporary exterior and interior partitions as indicated on the Phasing Plan in Section 01 32 00 – SCHEDULES AND REPORTS.

G. BID CATEGORY NO. 06 – FLOORING

Add the following Specification

Section 07 92 00 Joint Sealants

H. BID CATEGORY NO. 07 – MECHANICAL

Add the following Specification

Section 07 92 00 Joint Sealants

I. BID CATEGORY NO. 08 – ELECTRICAL

Add the following Specification

Section 07 92 00 Joint Sealants

C. **SPECIFICATION SECTION 00 31 00 – BID FORM**

Add the following Alternate:

1. Add Alternate No. 1 from C200 – Mill and Replace the Basketball Court.

D. SPECIFICATION SECTION 01 23 00 – ALTERNATES

Add the following Alternate:

1. Add Alternate No. 1 from C200 – Mill and Replace the Basketball Court.

E. SPECIFICATION SECTION 01 32 00 – SCHEDULES AND REPORTS

a. 1.03 GUIDELINE SCHEDULE

Add:

1. See Guideline Schedule attached.
2. See Phasing Plan attached.

Activity Name	Original Duration	Start	Finish	Calendar																														
				J	A	S	O	N	D	J	F	M	A	M	J	J	A	S	O	N	D	J	F	M	A	M								
KPS Winchell Elem. Classroom Addition	359	22-Jul-24	18-Dec-25	18-Dec-25, KPS Winchell Elem. Classroom Addition																														
Bidding and Contract Phase	44	22-Jul-24	20-Sep-24	20-Sep-24, Bidding and Contract Phase																														
Owner Advertisement and Posted to Planroom	0	22-Jul-24*		Owner Advertisement and Posted to Planroom																														
Pre-Bid Meeting	0		31-Jul-24	Pre-Bid Meeting																														
Addendum 01	0		07-Aug-24	Addendum 01																														
Bids Due	0	14-Aug-24*	14-Aug-24	Bids Due																														
Review and Post Bid Tabs	0		14-Aug-24	Review and Post Bid Tabs																														
Pre-Award Conferences	4	19-Aug-24*	22-Aug-24	Pre-Award Conferences																														
Letter of Recommendation	0		22-Aug-24	Letter of Recommendation																														
KPS Board Approval	0	23-Aug-24*		KPS Board Approval																														
Notice to Proceed	0	23-Aug-24*		Notice to Proceed																														
Contract Execution	20	23-Aug-24	20-Sep-24	Contract Execution																														
Construction Administration	335	23-Aug-24	18-Dec-25	18-Dec-25, Construction Administration																														
Submittals and Samples	45	23-Aug-24*	25-Oct-24	Submittals and Samples																														
Material Procurement	201	23-Aug-24*	09-Jun-25	Material Procurement																														
Pre-Construction Meeting	0	30-Aug-24		Pre-Construction Meeting																														
Procure Permits	20	01-Apr-25*	28-Apr-25	Procure Permits																														
Last Day of 2024/2025 School Year	0		06-Jun-25	Last Day of 2024/2025 School Year																														
Sitework Pre-Install Meeting	0	11-Jun-25		Sitework Pre-Install Meeting																														
Concrete Pre-Install Meeting	0	11-Jun-25		Concrete Pre-Install Meeting																														
Masonry Pre-Install Meeting	0	25-Jul-25		Masonry Pre-Install Meeting																														
Phase 1 Final Inspections	5	04-Aug-25*	08-Aug-25	Phase 1 Final Inspections																														
Phase 1 KPS, TP, and TSC Punch List Creation	1	04-Aug-25*	04-Aug-25	Phase 1 KPS, TP, and TSC Punch List Creation																														
Phase 1 Pnchlist Corrections	10	05-Aug-25*	18-Aug-25	Phase 1 Pnchlist Corrections																														
First Day of School 2025/2026 School Year	0	26-Aug-25*		First Day of School 2025/2026 School Year																														
Interior Finishes Pre-Install Meeting	0	30-Sep-25		Interior Finishes Pre-Install Meeting																														
Phase 2 50% and Above Ceiling Inspections	5	16-Oct-25	22-Oct-25	Phase 2 50% and Above Ceiling Inspections																														
Contractor Closeout Meeting	0	16-Oct-25		Contractor Closeout Meeting																														
Closeout Submittals Due	0		03-Nov-25	Closeout Submittals Due																														
Phase 2 Final M.E.P. Inspections	5	04-Nov-25	10-Nov-25	Phase 2 Final M.E.P. Inspections																														
Owner Training	5	04-Nov-25	10-Nov-25	Owner Training																														
Attic Stock Turnover	5	12-Nov-25	18-Nov-25	Attic Stock Turnover																														
Phase 2 Final BCC and BFS Inspections	5	19-Nov-25	25-Nov-25	Phase 2 Final BCC and BFS Inspections																														
Phase 2 KPS, TP, and TSC Punch List Creation	2	26-Nov-25	01-Dec-25	Phase 2 KPS, TP, and TSC Punch List Creation																														
Phase 2 Contractor Punch List Corrections	10	02-Dec-25	15-Dec-25	Phase 2 Contractor Punch List Corrections																														
Phase 2 Owner Move-In	5	12-Dec-25	18-Dec-25	Phase 2 Owner Move-In																														
Substantial Completion	0		18-Dec-25	Substantial Completion																														
Owner Occupancy	0		18-Dec-25	Owner Occupancy																														
Phase 1 - Existing Classroom Renovations (49	09-Jun-25	15-Aug-25	15-Aug-25, Phase 1 - Existing Classroom Renovations (C3 and C6)																														
Install Temp. Floor Protection and Plastic Barriers	2	09-Jun-25*	10-Jun-25	Install Temp. Floor Protection and Plastic Barriers																														
Interior Selective Architectural Demo	2	09-Jun-25	10-Jun-25	Interior Selective Architectural Demo																														

Actual Work

 Remaining Work

 Critical Remaining Work

 Milestone

 Summary



KPS Winchell Elem. Classroom Addition - 224010.03
Guideline Schedule - 17-Jul-24
 Page 1 of 3

The SKILLMAN Corporation
 Construction Management

Kalamazoo Public Schools Winchell Elementary Addition

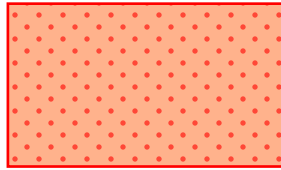

PHASING PLAN 7/29/2024

-  Phase 01
June 2025-August 2025
-  Phase 02
June 2025-December 2025

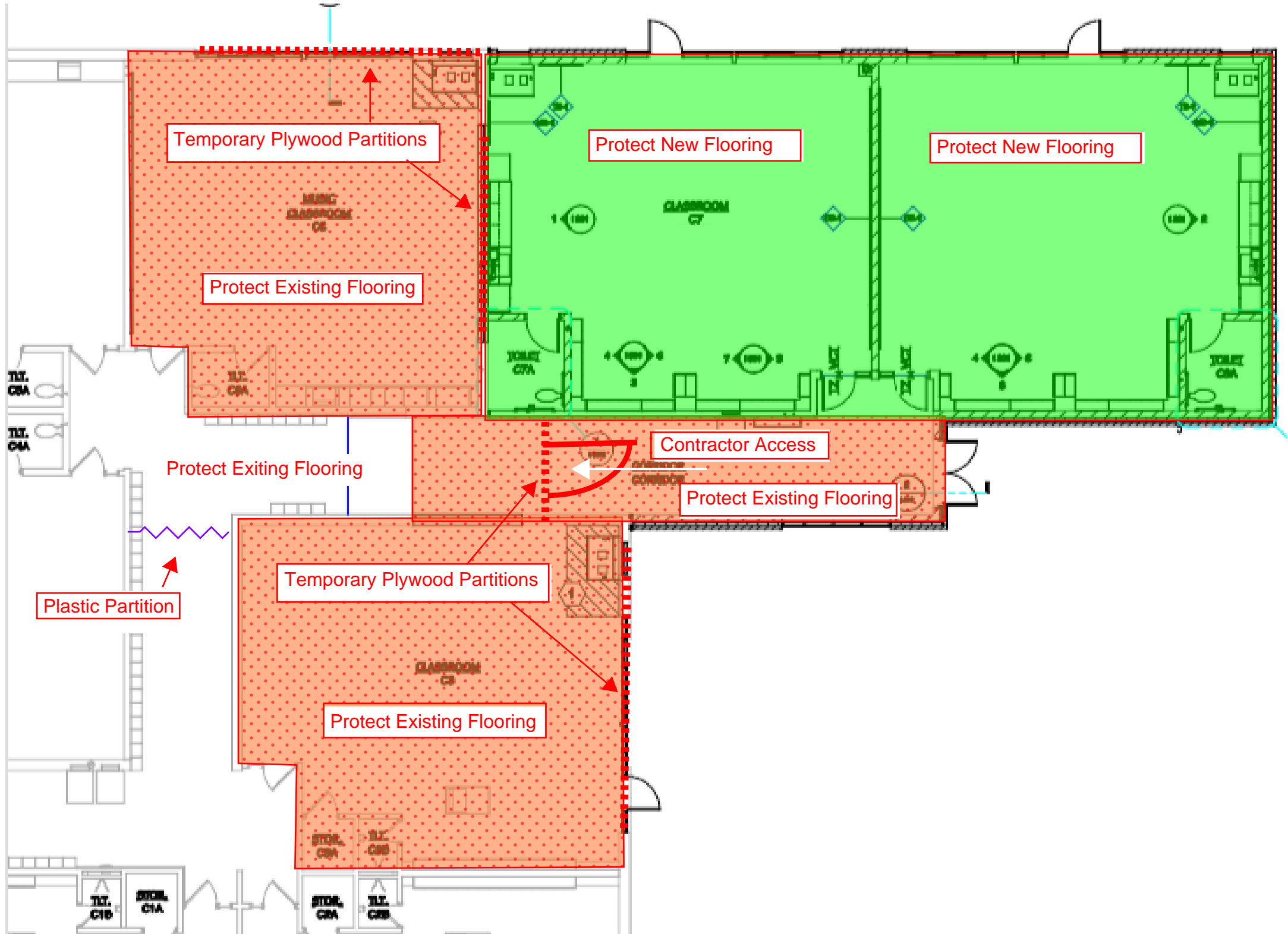

TowerPinkster
Architecture · Engineering · Interiors



The SKILLMAN Corporation
AN EMPLOYEE-OWNED COMPANY