

EXISTING STORM STRUCTURES

CB#1 - 2'Ø CONCRETE LEACHING BASIN RIM 941.92 (BEEHIVE) INV (W) 8" HDP=938.07 SUMP=936.42	CB#35 - 4'Ø CONCRETE LEACHING BASIN RIM 941.27 INV (NW) 12" CPP=937.40
CB#2 - 4'Ø CONCRETE LEACHING BASIN (BEEHIVE) (NO PIPES VISIBLE - SILT SACK PRESENT)	CB#36 - RIM 942.07 (BEEHIVE) (NO PIPES VISIBLE - FILLED WITH WATER)
CB#11 - 4'Ø CONCRETE LEACHING BASIN RIM 941.41 (BEEHIVE) INV (S) 12" HDP=937.63± INV (NW) 12" HDP=937.51± SUMP=935.73	CB#37 - 4'Ø CONCRETE LEACHING BASIN RIM 942.43 (BEEHIVE) INV (N) 12" HDP=938.16 SUMP=936.33
YD#12 - 8"Ø CLAY LEACHING BASIN RIM 935.28 (BEEHIVE) INV (W) 8" CLAY=932.83 SUMP=923.23	CB#38 - 2'Ø CONCRETE LEACHING BASIN RIM 942.77 (BEEHIVE) INV (SSE) 8" CPP=938.12 SUMP=937.42
CB#13 - 2'Ø BLOCK LEACHING BASIN RIM 935.90 INV (N) 8" CLAY=932.02 INV (E) 8" CLAY=932.35 INV (W) 6" CLAY=932.46 INV (S) 8" CLAY=932.02 SUMP=931.45	CB#39 - 4'Ø CONCRETE LEACHING BASIN RIM 942.68 (BEEHIVE) INV (NW) 8" CPP=937.58± INV (S) 12" HDP=937.58 SUMP=935.58
CB#22 - 2'Ø BLOCK LEACHING BASIN RIM 936.01 INV (S) 8" CLAY=931.21 INV (E) 8" CLAY=932.61 INV (N) 8" CLAY=931.21 INV (W) 6" CLAY=932.43 SUMP=930.49	CB#40 - RIM 942.02 (BEEHIVE) (NO PIPES VISIBLE - FILLED WITH WATER)
YD#23 - 8"Ø CLAY LEACHING BASIN RIM 935.41 (BEEHIVE) INV (W) 8" CLAY=933.11	
YD#24 - 12" PVC LEACHING BASIN RIM 935.70 INV (NNW) 6" PVC=933.02 SUMP=932.48	
CB#27 - 4'Ø CONCRETE LEACHING BASIN RIM 934.84 INV (W) 10" CLAY=930.89 INV (SSW) 8" CLAY=930.94 SUMP=930.34	

WORK FOR SOFTBALL AND BASEBALL TO BE ALTERNATE #2

LEGEND

	REMOVE EXISTING SIDEWALK, ADJACENT TO PRESS BOX, TO BE REPLACED WITH CONCRETE.
	LIMITS DRAINAGE IMPROVEMENTS AND BID ALTERNATE #2
	SAWCUT EXISTING ASPHALT/SIDEWALK
	REMOVE
	PROTECT

- DEMOLITION NOTES**
- CONTRACTOR SHALL POWERFLUSH ALL EXISTING DRAIN LINES AND CLEAN DEBRIS FROM SUMPS WITHIN LIMITS OF CONSTRUCTION. FIELD VERIFY THAT ALL EXISTING DRAIN LINES ARE FUNCTIONAL AND CONNECTED.
 - CONTRACTOR SHALL VERIFY LOCATIONS OF ALL ON-SITE UTILITIES PRIOR TO CONSTRUCTION ON THE CONTRACTOR'S BEHALF. WORK SHALL INCLUDE ENLISTING THE SERVICES OF A PRIVATE UTILITY LOCATOR AS REQUIRED.
 - ANY DEPRESSIONS CREATED DURING DEMOLITION ACTIVITIES SHALL BE BACKFILLED WITH CLASS II FILL MATERIAL UP TO PROPOSED SUBGRADE ELEVATION, IN 8 INCH LIFTS AND COMPACTED TO 95% OF MAXIMUM UNIT WEIGHT.
 - ALL CONTRACTORS ARE RESPONSIBLE TO PROTECT EXISTING WALKS, PAVEMENT, LAWNS, BUILDINGS, AND TREES SCHEDULED TO REMAIN THROUGH CONSTRUCTION.
 - ALL EXCESS SOIL SHALL BE EXPORTED OFFSITE UNLESS NOTED OTHERWISE
 - CONTRACTOR TO LOCATE, POWER WASH, AND CLEAN SUMPS OF ALL EXISTING CATCH BASINS AND STORM DRAIN AROUND THE PERIMETER OF CONSTRUCTION. CONTRACTOR TO ENSURE DRAINAGE SYSTEM HAS POSITIVE FLOW.
 - CONTRACTOR SHALL BE SOLELY RESPONSIBLE AND MAKE EVERY EFFORT TO LOCATE EXISTING UNDERGROUND UTILITIES. THIS SHALL INCLUDE CONSULTING WITH ALL LOCAL UTILITY COMPANIES AND USING A SIGNAL LOCATOR PRIOR TO EXCAVATION. ANY AND ALL REPAIRS SHALL BE COMPLETED WITHIN 48 HRS. OR THE OWNER SHALL HAVE THE REPAIR WORK COMPLETED AT THE CONTRACTORS EXPENSE.

ADDENDUM #1 01/17/2025
ISSUED FOR DATE

PROJECT TITLE
KALAMAZOO CENTRAL
HIGH SCHOOL
ATHLETICS PROJECT

OWNER
KALAMAZOO PUBLIC
SCHOOLS

Kalamazoo, Michigan

SHEET TITLE
EXISTING CONDITIONS - DEMO PLAN
JETER FIELD

DATE
DECEMBER 20, 2024

SHEET NUMBER
C 102
23623.00



PROJECT NUMBER: 24183001_KCHS



ALL UTILITIES AS SHOWN ARE APPROXIMATE LOCATIONS DERIVED FROM ACTUAL MEASUREMENTS AND AVAILABLE RECORDS. THEY SHOULD NOT BE INTERPRETED TO BE EXACT LOCATION NOR SHOULD IT BE ASSUMED THAT THEY ARE THE ONLY UTILITIES IN THE AREA. FIELD WORK PERFORMED BY: DRIESENGA & ASSOCIATES, INC.

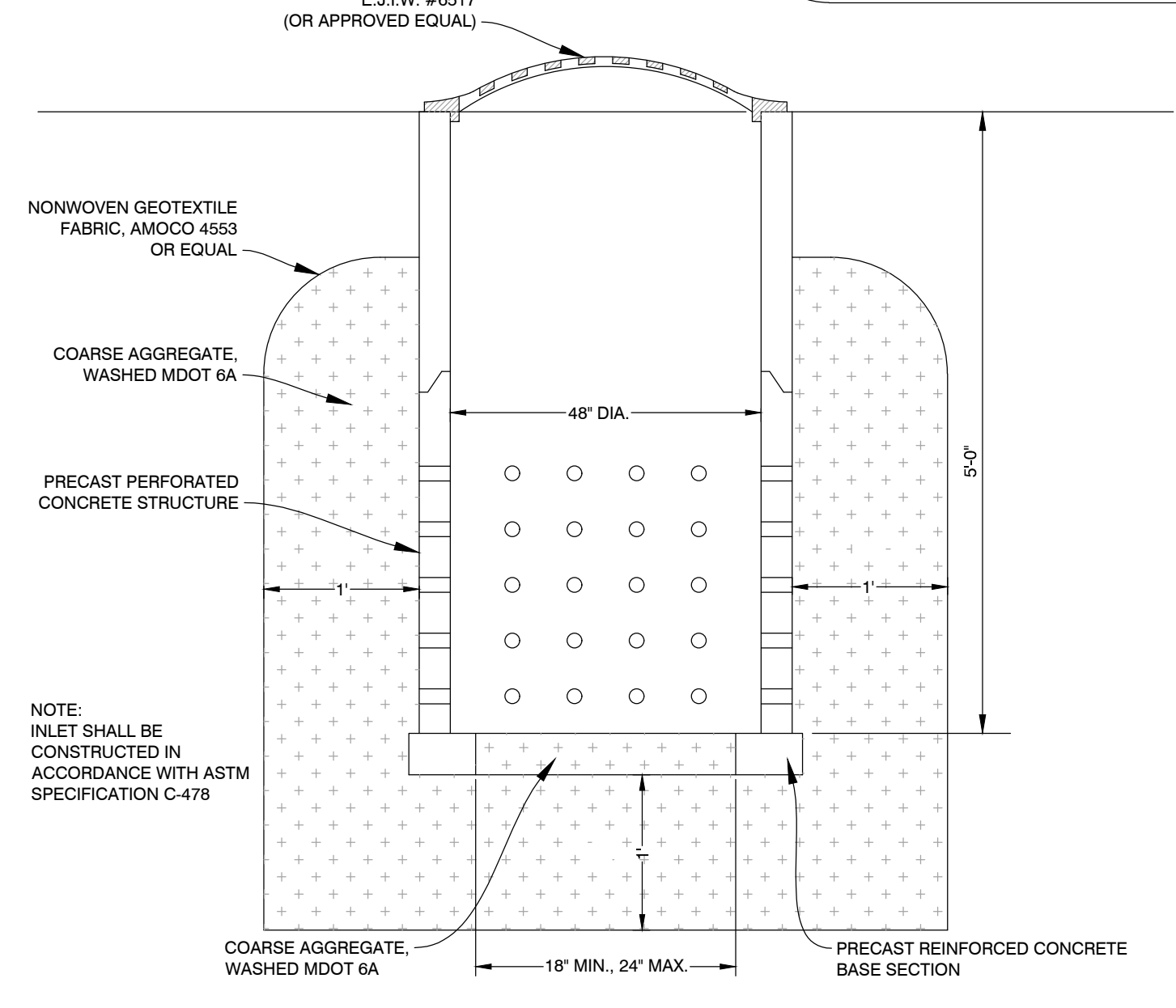
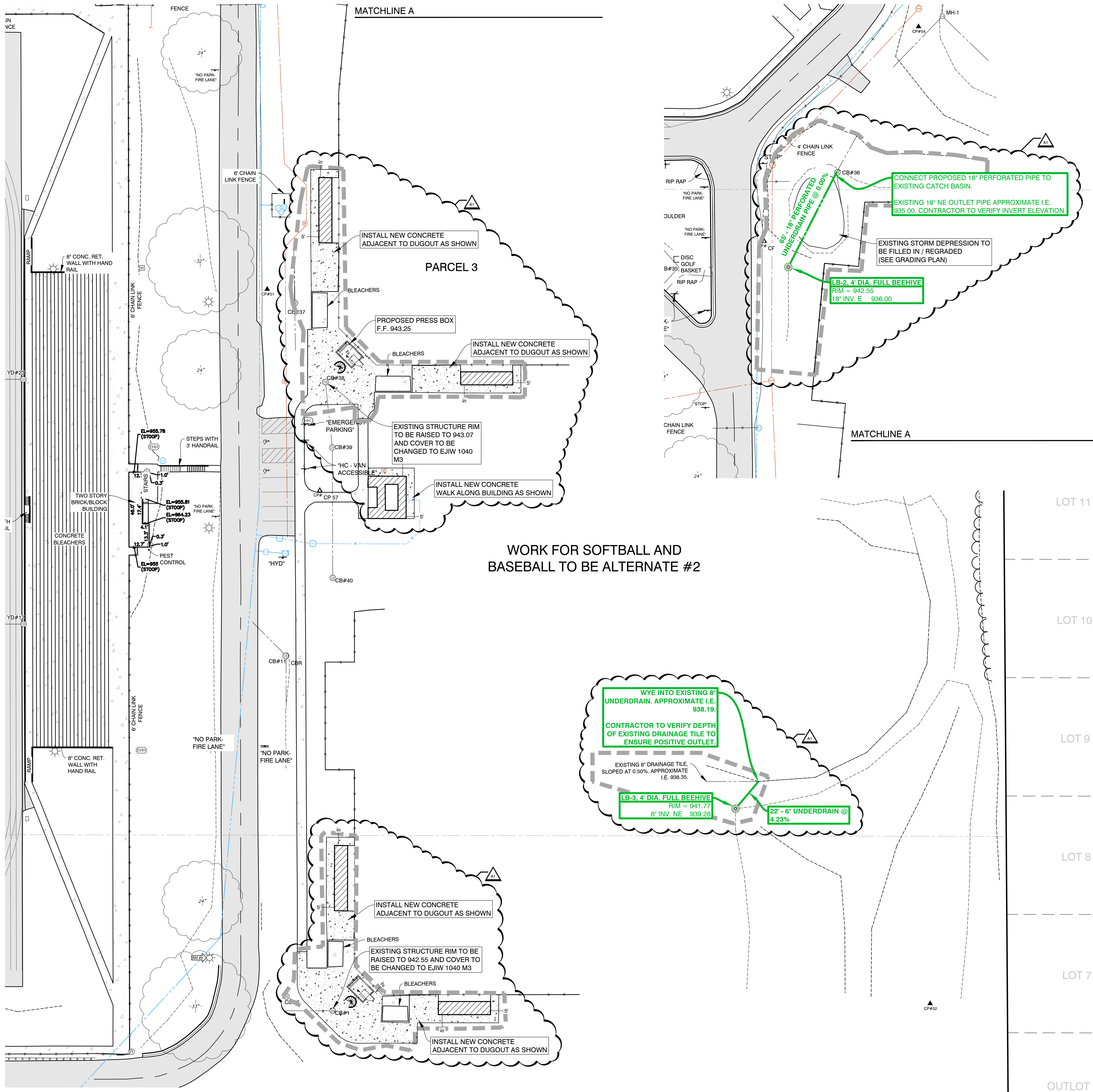
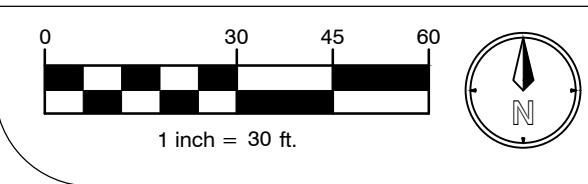

LEACHING BASIN DETAIL
NOT TO SCALE

LEGEND

- EXISTING PAVEMENT
- EXISTING CONCRETE
- 4\"/>

GENERAL NOTES

1. DIMENSIONS TAKE PRECEDENCE OVER SCALE. CONTRACTOR TO VERIFY ALL DIMENSIONS IN FIELD.
2. IF ANY ERRORS, DISCREPANCIES, OR OMISSIONS BECOME APPARENT, THESE SHALL BE BROUGHT TO THE ATTENTION OF THE ARCHITECT/ENGINEER PRIOR TO CONSTRUCTION OF ANYTHING AFFECTED SO THAT CLARIFICATION OR REDESIGN MAY OCCUR.
3. ALL CURB RADI AND DIMENSIONS ARE TO FACE OF CURB. CURB TO BE PROVIDED WHERE SHOWN AND INTEGRAL WITH SIDEWALK AT PAVING EDGE.
4. SLOPE GRADES UNIFORMLY BETWEEN ELEVATIONS SHOWN. NOMINAL GRADING, SLOPE SIDEWALKS AWAY FROM BUILDING AT 1/4\"/>

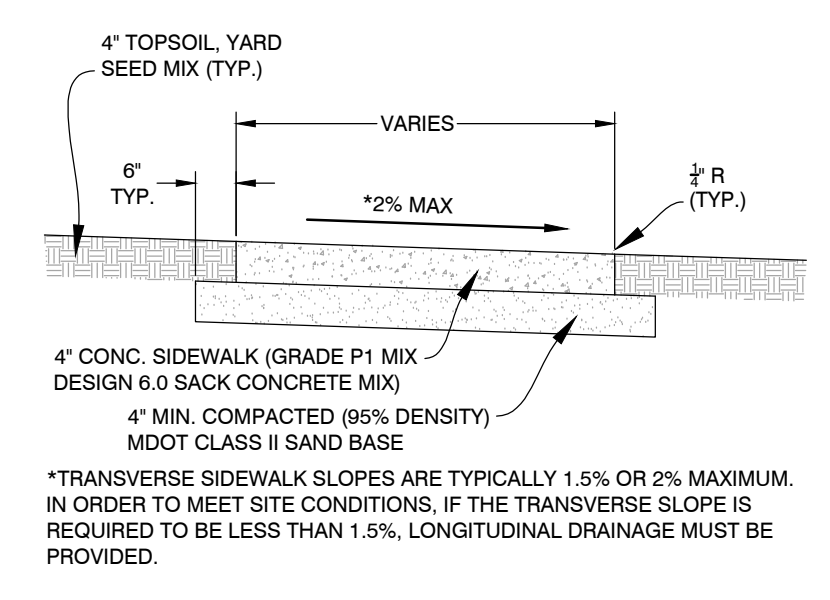

SIDEWALK SECTION
NOT TO SCALE

ADDENDUM #1 01/17/2025
ISSUED FOR DATE

PROJECT TITLE
**KALAMAZOO CENTRAL
HIGH SCHOOL
ATHLETICS PROJECT**

OWNER
**KALAMAZOO PUBLIC
SCHOOLS**
Kalamazoo, Michigan

SHEET TITLE
**SITE LAYOUT - UTILITY PLAN
JETER FIELD**

DATE
DECEMBER 20, 2024

SHEET NUMBER
C 202
23623.00

PROJECT NUMBER: 24183001_KCHS

ALL UTILITIES AS SHOWN ARE APPROXIMATE LOCATIONS DERIVED FROM ACTUAL MEASUREMENTS AND AVAILABLE RECORDS. THEY SHOULD NOT BE INTERPRETED TO BE EXACT LOCATION NOR SHOULD IT BE ASSUMED THAT THEY ARE THE ONLY UTILITIES IN THE AREA. FIELD WORK PERFORMED BY: DRIESENGA & ASSOCIATES, INC.

GRADING NOTES

1. ALL WORK SHALL CONFORM TO ALL LOCAL, STATE AND FEDERAL LAWS, RULES AND REGULATIONS IN FORCE AT TIME OF CONSTRUCTION.
2. THE GENERAL CONTRACTOR SHALL BE RESPONSIBLE FOR OBTAINING ALL PERMITS, PERMIT COSTS, TAP FEES, METER DEPOSITS, PERMANENT UTILITY APPLICATIONS, BONDS, AND OTHER FEES REQUIRED FOR PROPOSED WORK. THIS SHALL INCLUDE, BUT SHALL NOT BE LIMITED TO THOSE REQUIRED BY THE MICHIGAN DEPARTMENT OF TRANSPORTATION.
3. CONTACT MISS DIG "811" FOR LOCATION OF UNDERGROUND UTILITIES A MINIMUM OF 48 HOURS BEFORE COMMENCING EXCAVATION WORK. THIS DOES NOT RELIEVE THE CONTRACTOR OF THE RESPONSIBILITY OF NOTIFYING UTILITY OWNERS WHO ARE NOT PART OF THE "MISS DIG" ALERT SYSTEM. THE CONTRACTOR SHALL CONDUCT HIS OPERATIONS IN A MANNER AS TO ENSURE THAT THOSE UTILITIES NOT REQUIRING RELOCATION WILL NOT BE DISTURBED.
4. DEMOLISH & REMOVE ALL EXISTING SITE FEATURES AS REQUIRED.
5. MATCH EXISTING GRADES AROUND PERIMETER WITH SLOPES AS SHOWN.
6. ALL SPOT ELEVATIONS ARE TOP OF PAVEMENT GRADES AT EDGE OF METAL (EOM) UNLESS OTHERWISE NOTED.
7. ALL SOIL EROSION CONTROL MEASURES SHALL BE IN PLACE PRIOR TO MASS GRADING.
8. ALL EARTHWORK SHALL BE IN ACCORDANCE WITH THE TECHNICAL SPECIFICATIONS AND GEOTECHNICAL REPORT.
9. ALL EXISTING ELEVATIONS ARE TO BE VERIFIED AND ACCEPTED AS SHOWN PRIOR TO COMMENCEMENT OF WORK.
10. CONTRACTOR SHALL TAKE PRECAUTIONS TO AVOID TRACKING SOIL ONTO ADJACENT ROADWAYS. CONTRACTOR SHALL SWEEP IMMEDIATELY IF OCCURS.
11. ANY DISTURBED AREA WHICH WILL BE LEFT UNWORKED 15 DAYS OR LONGER MUST BE SEED TO ESTABLISH VEGETATION FOR TEMPORARY STABILIZATION. BASINS TO BE SEED AND MULCH BLANKETS APPLIED IMMEDIATELY TO PROVIDE A STABLE BASE AND AVOID EXCESSIVE EROSION.
12. CONTRACTOR TO MAINTAIN POSITIVE DRAINAGE DURING ALL EARTHWORK OPERATIONS.
13. TOPSOIL AND SEED ALL AREAS DISTURBED AND NOT OTHERWISE DEVELOPED. ALL WORK I.E. DEMOLITION AND REMOVALS, DRAINAGE WORK, STONE AND ASPHALT, FENCING, TRACK SURFACE, ETC. SHALL BE COMPLETED BY DATE AS NOTED IN CONTRACT DOCUMENTS. ALL LAWN AREAS SHALL SLOPE TO DRAINAGE STRUCTURES.
14. CONTRACTOR SHALL ENSURE ADJACENT STORM STRUCTURES AND PROPOSED STORM STRUCTURES ARE CLEANED ONCE CONSTRUCTION IS COMPLETE.

SOIL EROSION & SEDIMENT CONTROL NOTES

1. ALL CONSTRUCTION METHODS SHALL BE DONE IN COMPLIANCE WITH MDOT-EGLE. THE OWNER SHALL BE RESPONSIBLE FOR OBTAINING A "SOIL EROSION PERMIT" FROM THE GOVERNING AUTHORITY AND A "PERMIT BY RULE/NOTICE OF COVERAGE" FROM THE GOVERNING AUTHORITY, IF APPLICABLE, PRIOR TO START OF CONSTRUCTION. THE CONTRACTOR SHALL BE RESPONSIBLE FOR COMPLYING WITH ALL REQUIREMENTS OF THE "SOIL EROSION PERMIT" AND FOR ALL CERTIFIED STORM WATER INSPECTION SERVICE REQUIRED BY THE "PERMIT BY RULE." EROSION CONTROL MEASURES SHOWN ON THE PLANS ARE THE MINIMUM REQUIREMENTS AND SHALL NOT RELIEVE THE CONTRACTOR'S RESPONSIBILITY FOR PROVIDING ALL REQUIRED EROSION CONTROL MEASURES.
 2. AVOID UNNECESSARY DISTURBING OR REMOVING OF EXISTING VEGETATED TOPSOIL OR EARTH COVER. THESE COVER AREAS ACT AS SEDIMENT FILTERS.
 3. ALL TEMPORARY SOIL EROSION PROTECTION SHALL REMAIN IN PLACE UNTIL REMOVAL IS REQUIRED FOR FINAL CLEAN UP AND APPROVAL.
 4. GEOTEXTILE SILT FENCE SHALL BE INSTALLED AS REQUIRED WHEN CROSSING CREEKS OR WHEN ADJACENT TO WETLANDS OR SURFACE WATER BODIES TO PREVENT SILTATION AND ELSEWHERE AS DIRECTED BY THE ENGINEER. SEEDING AND/OR SODDING SHALL BE INSTALLED ON CREEK BANKS IMMEDIATELY AFTER CONSTRUCTION TO PREVENT EROSION.
 5. MAINTENANCE, CLEANING, AND REMOVAL OF THE VARIOUS SEDIMENT CONTROL MEASURES SHALL BE INCLUDED IN THE VARIOUS EROSION CONTROL ITEMS.
- ALL SOIL EROSION AND SEDIMENTATION CONTROL MEASURES SHALL BE PER MDOT STANDARD DETAILS. "P" DENOTES PERMANENT MEASURE AND "T" DENOTES TEMPORARY MEASURE. SOIL EROSION CONTROL PLANS DENOTE MINIMUM EROSION MEASURES REQUIRED AS DESCRIBED BELOW.
- Ⓝ DENOTES DUST CONTROL. DUST CONTROL MAY BE REQUIRED ON THE SUBGRADE CONSTRUCTION AND WILL INCLUDE APPLYING FRESH WATER TO BE INCLUDED IN THE ITEM OF EMBANKMENT. DUST CONTROL ON THE AGGREGATE BASE COURSE WILL BE ACCOMPLISHED BY APPLYING FRESH WATER (INCLUDED IN THE ITEM OF AGGREGATE BASE, 6 INCH) AND APPLYING DUST PALLIATIVE, APPLIED, CA₂, (TON) AS DIRECTED BY THE PROJECT ENGINEER.
- ⓈP DENOTES AGGREGATE COVER/PERMANENT PAVEMENT RESTORATION
- Ⓢ DENOTES GRAVEL ACCESS APPROACH. APPROACH SHALL BE INSTALLED TO PROVIDE STABLE ACCESS TO ROADWAYS AND MINIMIZE DUST AND TRACKING OF MATERIALS ONTO PUBLIC STREETS AND HIGHWAYS. THE APPROACH SHALL BE A MINIMUM OF 12' WIDE, 6" DEEP, AND CONSIST OF 2"-4" AGGREGATE.
- ⓈI DENOTES INLET PROTECTION FABRIC DROP. SHALL BE INSTALLED AT EXISTING AND PROPOSED STORM SEWER INLETS TO PROVIDE SETTLING AND FILTERING OF SILT LADEN WATER PRIOR TO ENTRY INTO THE DRAINAGE SYSTEM.
- Ⓢ DENOTES PERMANENT SEEDING. ALL DISTURBED AREAS NOT PAVED OR GRAVELED SHALL BE RESTORED. PLACE TOPSOIL SURFACE, SALV, 3 INCH, MDOT SEEDING, MIXTURE TUF APPLIED AT A RATE OF 220 LB/ACRE, FERTILIZER, CHEMICAL NUTRIENT, CL A APPLIED AT A RATE OF 225 LB/ACRE, MULCH AT A RATE OF 2 TON/ACRE AND MULCH ANCHORING. (APPLIES TO ENTIRE PROJECT)

GENERAL NOTES

1. DIMENSIONS TAKE PRECEDENCE OVER SCALE. CONTRACTOR TO VERIFY ALL DIMENSIONS IN FIELD.
2. IF ANY ERRORS, DISCREPANCIES, OR OMISSIONS BECOME APPARENT, THESE SHALL BE BROUGHT TO THE ATTENTION OF THE ARCHITECT/ENGINEER PRIOR TO CONSTRUCTION OF ANYTHING AFFECTED SO THAT CLARIFICATION OR REDESIGN MAY OCCUR.
3. ALL CURB RADII AND DIMENSIONS ARE TO FACE OF CURB. CURB TO BE PROVIDED WHERE SHOWN AND INTEGRAL WITH SIDEWALK AT PAVING EDGE.
4. SLOPE GRADES UNIFORMLY BETWEEN ELEVATIONS SHOWN. NOMINAL GRADING, SLOPE SIDEWALKS AWAY FROM BUILDING AT 1/4" PER FOOT ON ENTRY WALK.

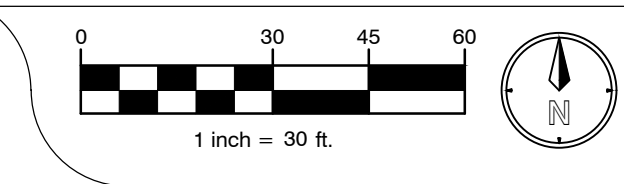
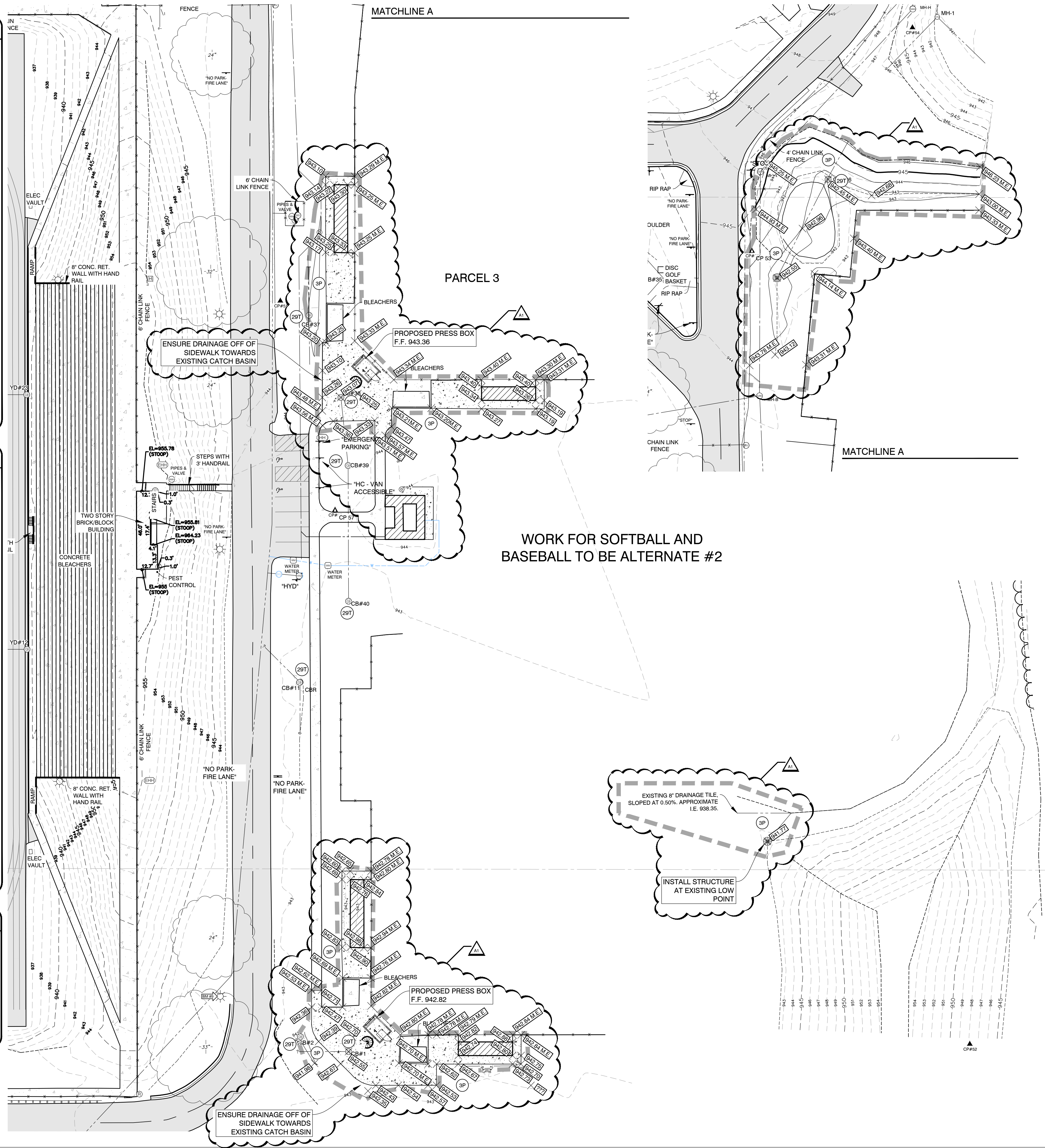

ADDENDUM #1 01/17/2025
ISSUED FOR DATE

PROJECT TITLE
KALAMAZOO CENTRAL
HIGH SCHOOL
ATHLETICS PROJECT

OWNER
KALAMAZOO PUBLIC
SCHOOLS
Kalamazoo, Michigan

DATE
DECEMBER 20, 2024

SHEET TITLE
GRADING - SESC PLAN
JETER FIELD

SHEET NUMBER
C 302
23623.00

TowerPinkster
Architecture · Engineering · Interiors
TOWERPINKSTER.COM
© 2025 ALL RIGHTS RESERVED

FORESITE DESIGN, INC.
A: 3249 Coolidge Highway
Berke, Michigan 49072
C: 248-547-7757
www.foresitedesign.com

AR ENGINEERING
CIVIL ENGINEERING & SURVEYING
MICHIGAN | INDIANA | ILLINOIS | OHIO
285.252.9591 PHONE | 866.993.0884 FAX
www.ar-engineeringllc.com

PROJECT NUMBER: 24183001_KCHS

811 Know what's below.
Call before you dig.

ALL UTILITIES AS SHOWN ARE APPROXIMATE LOCATIONS DERIVED FROM ACTUAL MEASUREMENTS AND AVAILABLE RECORDS. THEY SHOULD NOT BE INTERPRETED TO BE EXACT LOCATION NOR SHOULD IT BE ASSUMED THAT THEY ARE THE ONLY UTILITIES IN THE AREA. FIELD WORK PERFORMED BY: DRIESENGA & ASSOCIATES, INC.

LEGEND

EXISTING	PROPOSED
○ SPOT ELEVATION	XXXXX SPOT GRADE
XXXXX AS-BUILT SPOT ELEVATION	T/XXXXX TOP OF WALL ELEVATION
-X-X- FENCE	T/XXXXX TOP OF CURB ELEVATION
⊕ DRAINAGE STRUCTURE	X ME XXXXX MATCH EXISTING ELEVATION
ST STORM DRAIN	T/XXXXX TOP OF TRENCH ELEVATION
○ LIGHT POLE	← DRAINAGE SWALE
-E- ELECTRICAL	-X-X- CHAINLINK FENCE - SEE PLANS FOR HT.
-W- WATER	○ ORNAMENTAL FENCE - SEE PLANS FOR HT.
-T- TELEPHONE	⊕ DRAINAGE STRUCTURE
-IRR- IRRIGATION	ST STORM DRAIN
-P- PROPERTY	FLAT DRAIN
-SS- SANITARY	-4- 4' PERFORATED DRAINTILE
-GAS- GAS	-6- 6' PERFORATED DRAINTILE
	-8- 8' PERFORATED DRAINTILE
	○ LIGHT POLE
	-E- ELECTRICAL
	-W- WATER
	-T- TELEPHONE
	-IRR- IRRIGATION
	--- LIMITS OF CONSTRUCTION

- ### DEMOLITION NOTES:
- CONTRACTOR SHALL POWERFLUSH ALL EXISTING DRAIN LINES AND CLEAN DEBRIS FROM SUMPS WITHIN LIMITS OF CONSTRUCTION. FIELD VERIFY THAT ALL EXISTING DRAIN LINES ARE FUNCTIONAL AND CONNECTED.
 - CONTRACTOR SHALL VERIFY LOCATIONS OF ALL ON-SITE UTILITIES PRIOR TO CONSTRUCTION ON THE CONTRACTOR'S BEHALF. WORK SHALL INCLUDE ENLISTING THE SERVICES OF A PRIVATE UTILITY LOCATOR AS REQUIRED.
 - ANY DEPRESSIONS CREATED DURING DEMOLITION ACTIVITIES SHALL BE BACKFILLED WITH CLASS II FILL MATERIAL UP TO PROPOSED SUBGRADE ELEVATION, IN 8 INCH LIFTS AND COMPACTED TO 95% OF MAXIMUM UNIT WEIGHT.
 - ALL CONTRACTORS ARE RESPONSIBLE TO PROTECT EXISTING WALKS, PAVEMENT, LAWNS, BUILDINGS, AND TREES SCHEDULED TO REMAIN THROUGH CONSTRUCTION.
 - ALL EXCESS SOIL SHALL BE EXPORTED OFFSITE UNLESS NOTED OTHERWISE

- ### DEMOLITION LEGEND:
- FURNISH AND INSTALL PROTECTION OVER EXISTING TRACK. PROTECTION SHALL BE LEFT ONSITE UNTIL WORK BY ALL TRADES IS COMPLETE
 - REMOVE EXISTING IRRIGATION SYSTEM VALVES, LATERAL LINES AND HEADS. MAINLINE IN FIELD TO REMAIN.
 - STRIP TOPSOIL AND SPOILS. TRUCK TO LOCATION NOTED ON SITE. ALL EXCESS SOIL SHALL BE EXPORTED OFFSITE UNLESS NOTED OTHERWISE. MAINTAIN POSITIVE DRAINAGE DURING ALL EARTHWORK OPERATIONS.
 - LOCATE, POWER WASH, AND CLEAN SUMPS OF ALL EXISTING CATCH BASINS AND STORM DRAIN AROUND THE PERIMETER OF THE STADIUM. CONTRACTOR SHALL ENSURE DRAINAGE SYSTEM HAS POSITIVE FLOW.
 - REMOVE AND DISPOSE EXISTING FOOTBALL GOAL POSTS, FLAG POLE, AND FOOTINGS. REFER TO ELECTRICAL FOR SCOREBOARD DEMOLITION. PARTIALLY REMOVE EXISTING CONCRETE FOOTINGS TO MIN. 12" BELOW FINISH GRADE. CONTRACTOR SHALL BACKFILL AND TAMP HOLES FROM FOOTING REMOVAL.
 - SAWCUT EXISTING ASPHALT EDGE OF TRACK. FIELD VERIFY LIMITS WITH ARCHITECT PRIOR TO SAWCUTTING OPERATIONS (41588LP).
 - REMOVE EXISTING CHAINLINK FABRIC, POSTS, RAILS, HARDWARE, AND FOOTINGS. BACKFILL AND TAMP HOLES FROM FOOTING REMOVAL.
 - ADJUST EXISTING CATCH BASIN RIM ELEVATION



- NOTES AND LEGEND SHALL APPLY TO ALL SHEETS AND ALL SITES
- CONTRACTOR SHALL BE SOLELY RESPONSIBLE AND MAKE EVERY EFFORT TO LOCATE EXISTING UNDERGROUND UTILITIES. THIS SHALL INCLUDE CONSULTING WITH ALL LOCAL UTILITY COMPANIES AND USING A SIGNAL LOCATOR PRIOR TO EXCAVATION. ANY AND ALL REPAIRS SHALL BE COMPLETED WITHIN 48 HRS. OR THE OWNER SHALL HAVE THE REPAIR WORK COMPLETED AT THE CONTRACTORS EXPENSE.
- TOPSOIL AND SEED ALL AREAS DISTURBED AND NOT OTHERWISE DEVELOPED. ALL WORK IE DEMOLITION AND REMOVALS, DRAINAGE WORK, STONE AND ASPHALT FENCINGS, TRACK SURFACE, ETC. SHALL BE COMPLETED BY DATE AS NOTED IN CONTRACT DOCUMENTS. ALL LAWN AREAS SHALL SLOPE TO DRAINAGE STRUCTURES.
- ALL CONTOURS AND SPOT GRADES REFER TO FINISH GRADE OF LAWN, ASPHALT, OR CONCRETE. DO NOT FACTOR IN THE ALL-WEATHER SURFACE OR ACRYLIC COATING DEPTH.

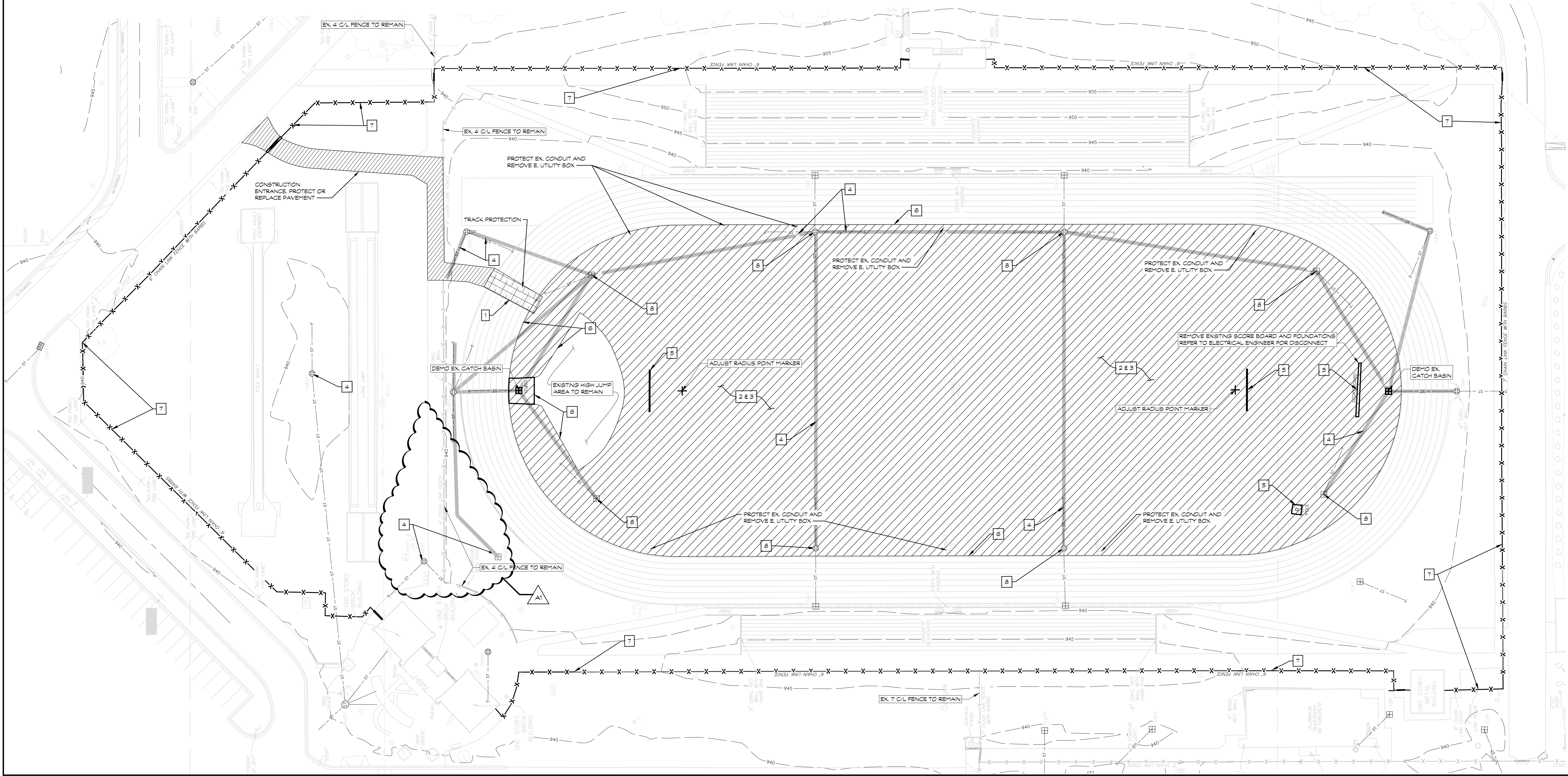
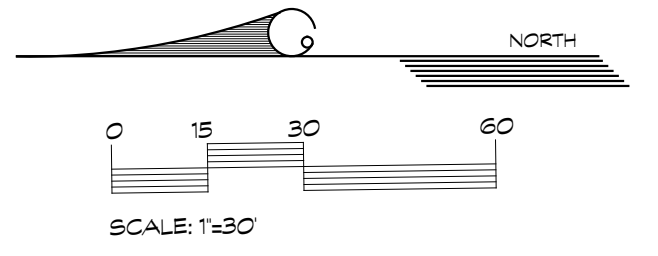
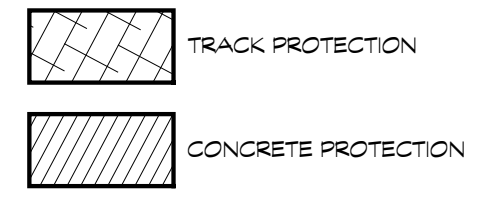

ADDENDUM No. 1 JANUARY 17, 2025
ISSUED FOR _____ DATE _____

PROJECT TITLE
KALAMAZOO CENTRAL
HIGH SCHOOL
ATHLETICS
PROJECT - BID
PACKAGE 2

OWNER
KALAMAZOO PUBLIC
SCHOOLS
Kalamazoo, Michigan

SHEET TITLE
DEMOLITION PLAN

DATE
DECEMBER 20, 2024

SHEET NUMBER
L501
23-625.00

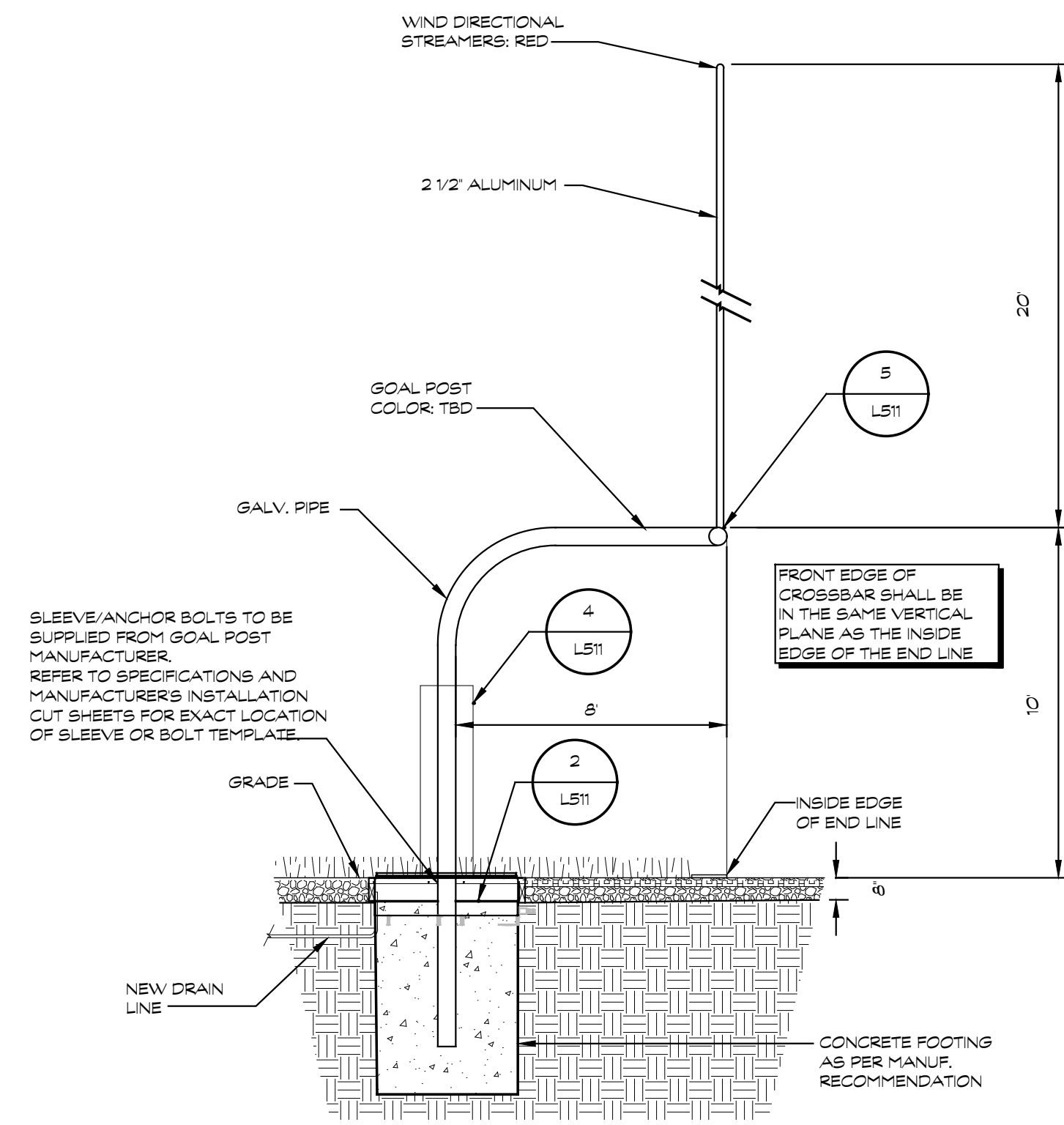

1 FOOTBALL GOAL POST FOUNDATION
SCALE 1/4"=1'-0"

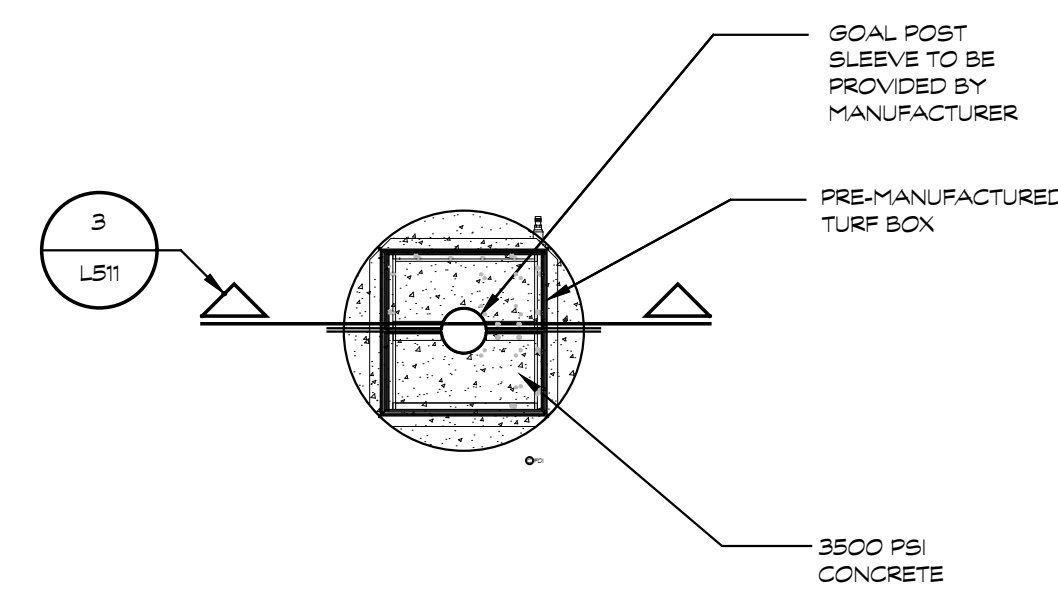

2 GOAL POST FOOTING/TURF DETAIL
SCALE 1/8"=1'-0"

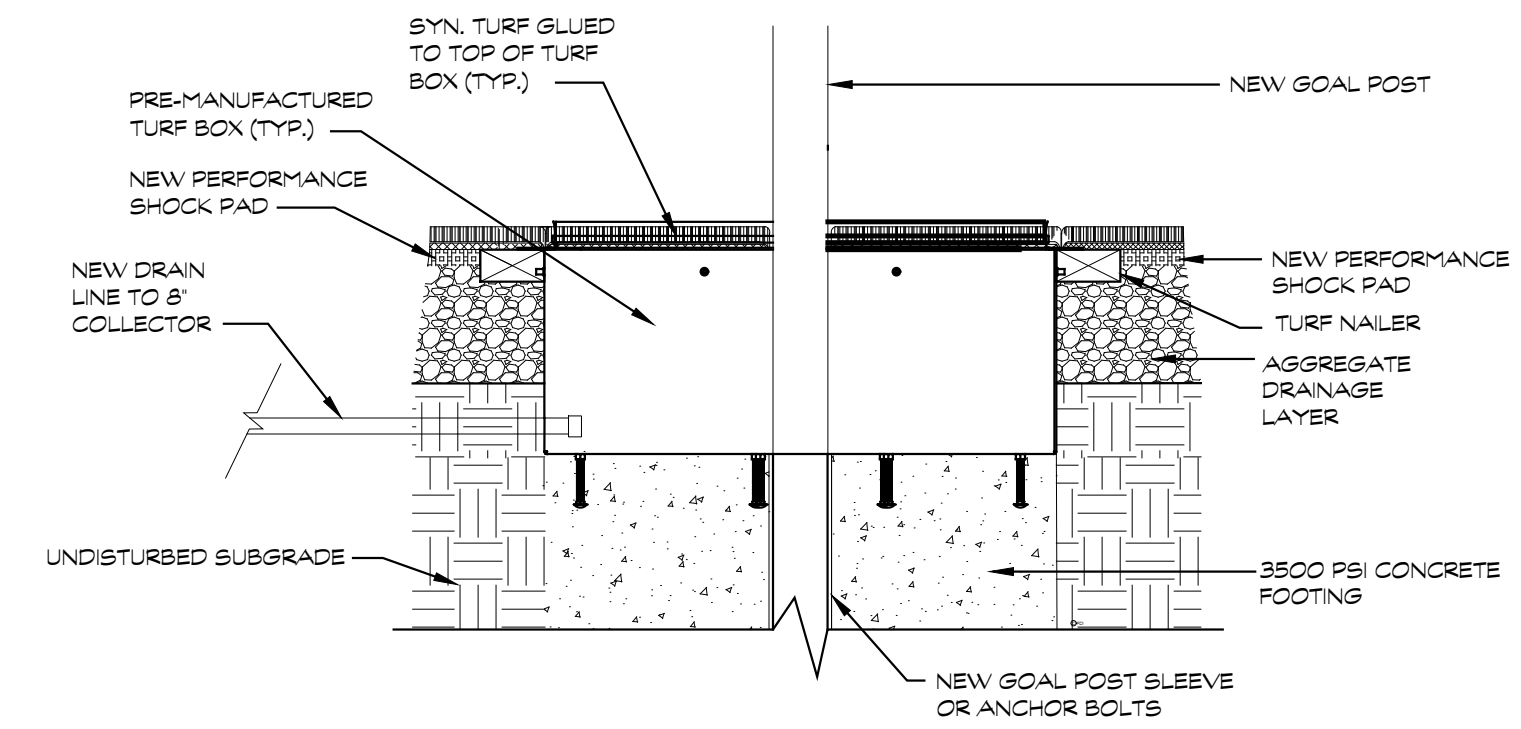

3 GOAL POST FOOTING/TURF DETAIL
SCALE 1/4"=1'-0"

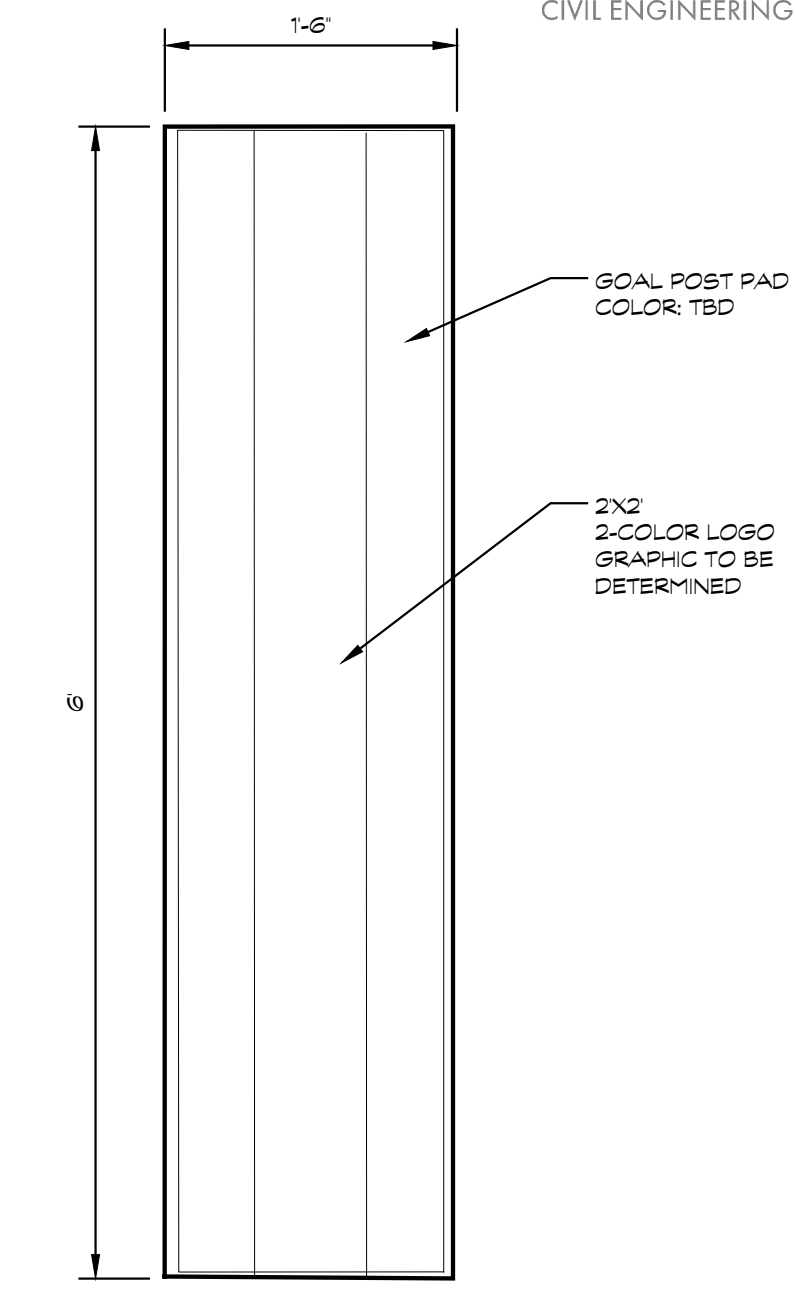

4 FOOTBALL GOAL POST PAD
SCALE 1/4"=1'-0"

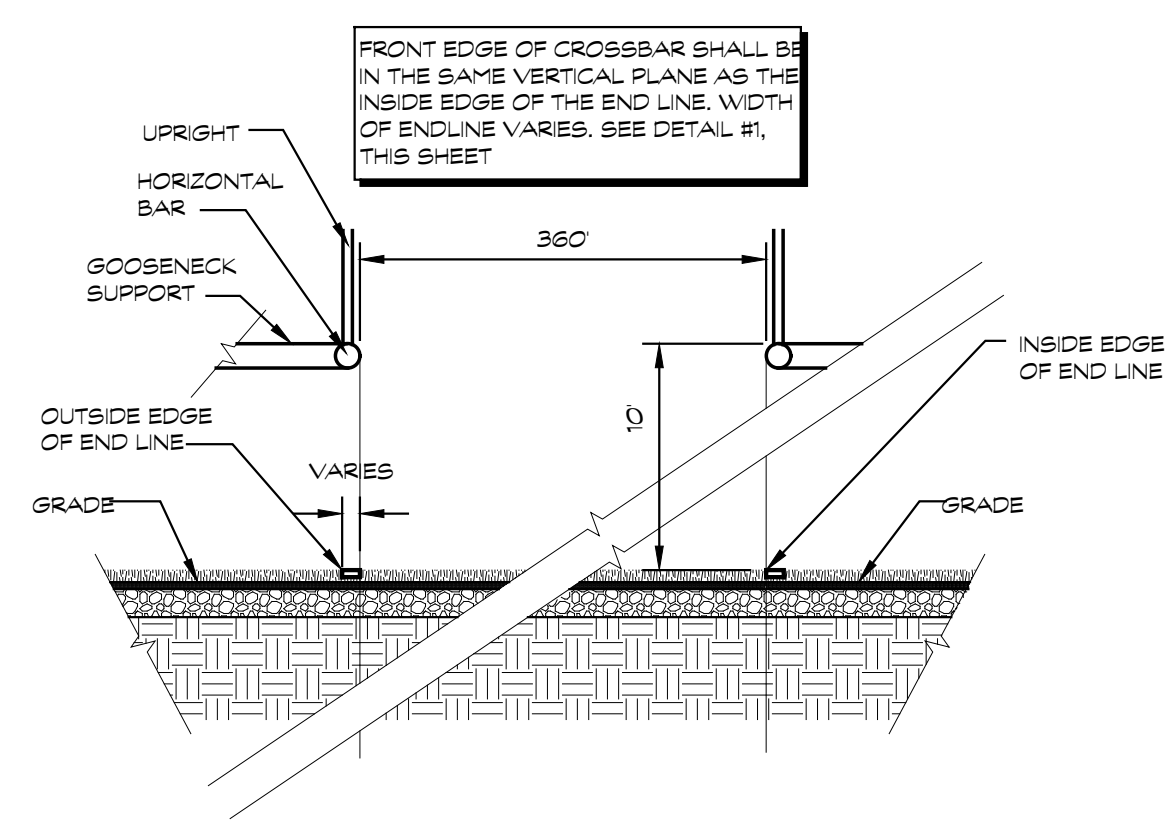

5 HORIZONTAL BAR ORIENTATION
SCALE 1/4"=1'-0"

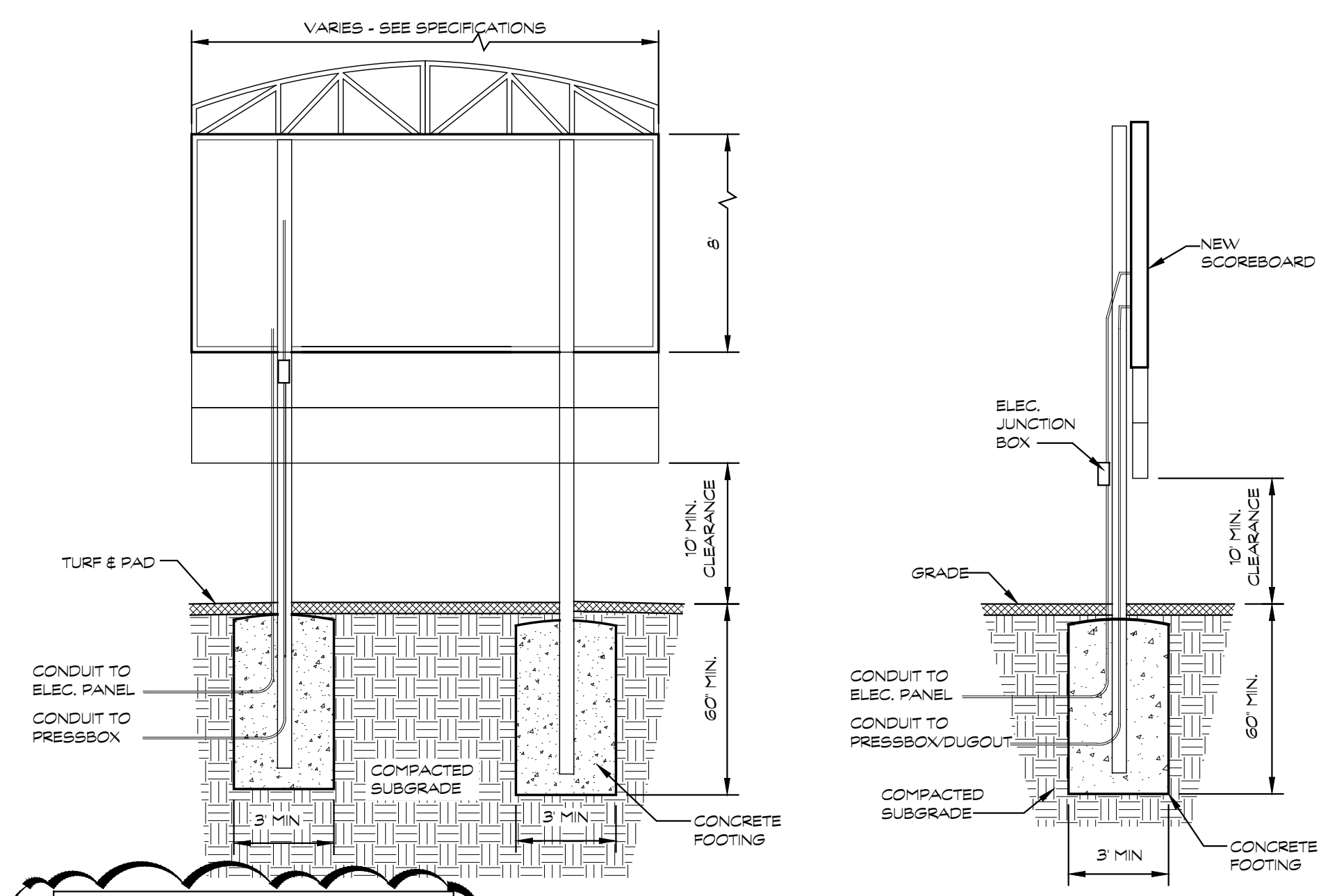

FOUNDATION AND STEEL PER MANUFACTURER'S DELEGATED DESIGN BASED ON SITE CONDITIONS. STEEL SHALL BE SIZED FOR FUTURE EXPANSION OF VIDEO BOARD, REFER TO SOIL REPORT.
SEE ELECTRICAL DWGS FOR INFORMATION RELATED TO POWER

6 SCOREBOARD DETAIL
SCALE 1/4"=1'-0"

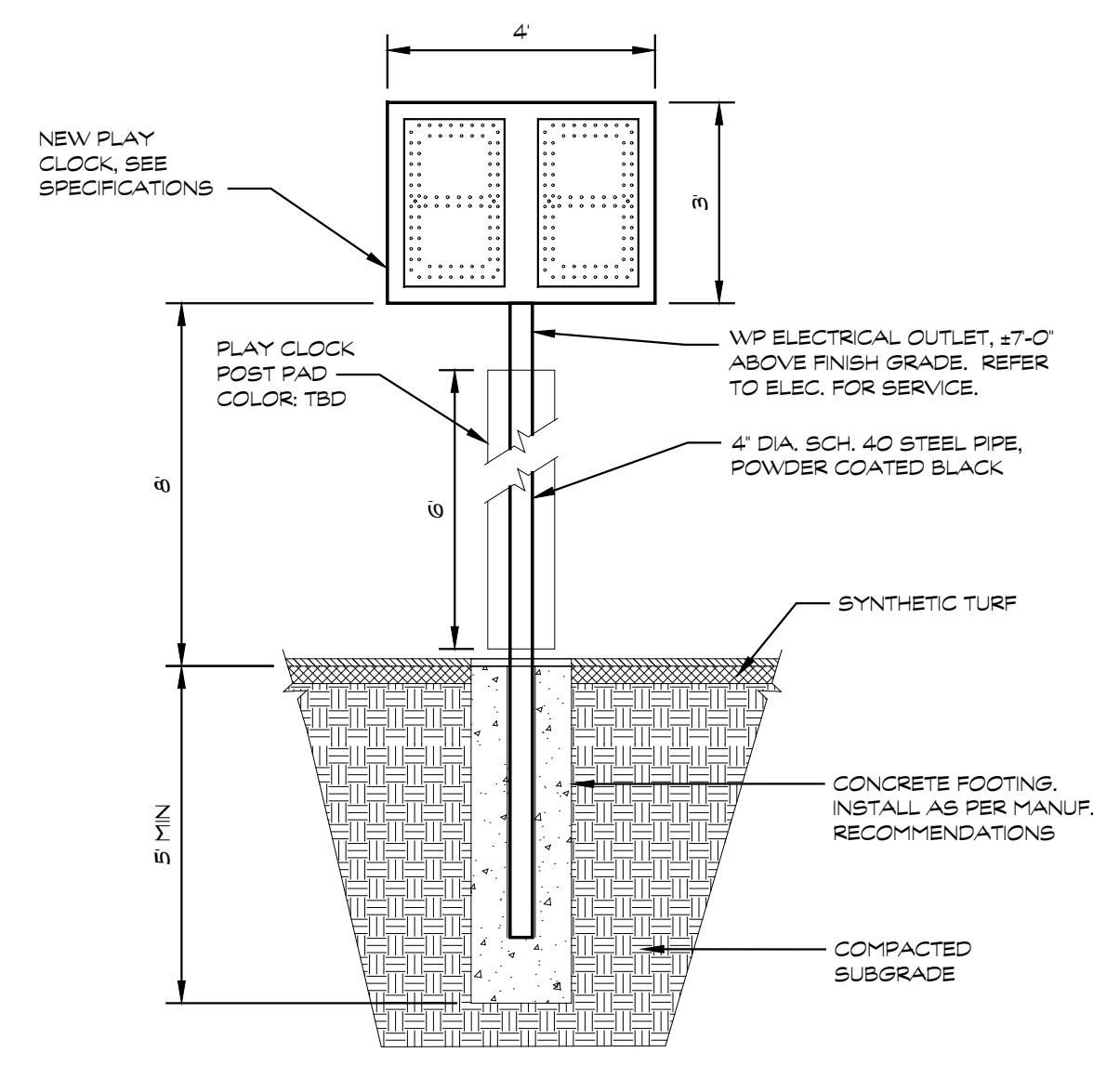

7 GAME CLOCK DETAIL
SCALE 3/8"=1'-0"

ADDENDUM No. 1 JANUARY 17, 2025
ISSUED FOR DATE

PROJECT TITLE
KALAMAZOO CENTRAL
HIGH SCHOOL
ATHLETICS
PROJECT - BID
PACKAGE 2

OWNER
KALAMAZOO PUBLIC
SCHOOLS
Kalamazoo, Michigan

SHEET TITLE
SITE DETAILS

DATE
DECEMBER 20, 2024

SHEET NUMBER
L511
23-625.00

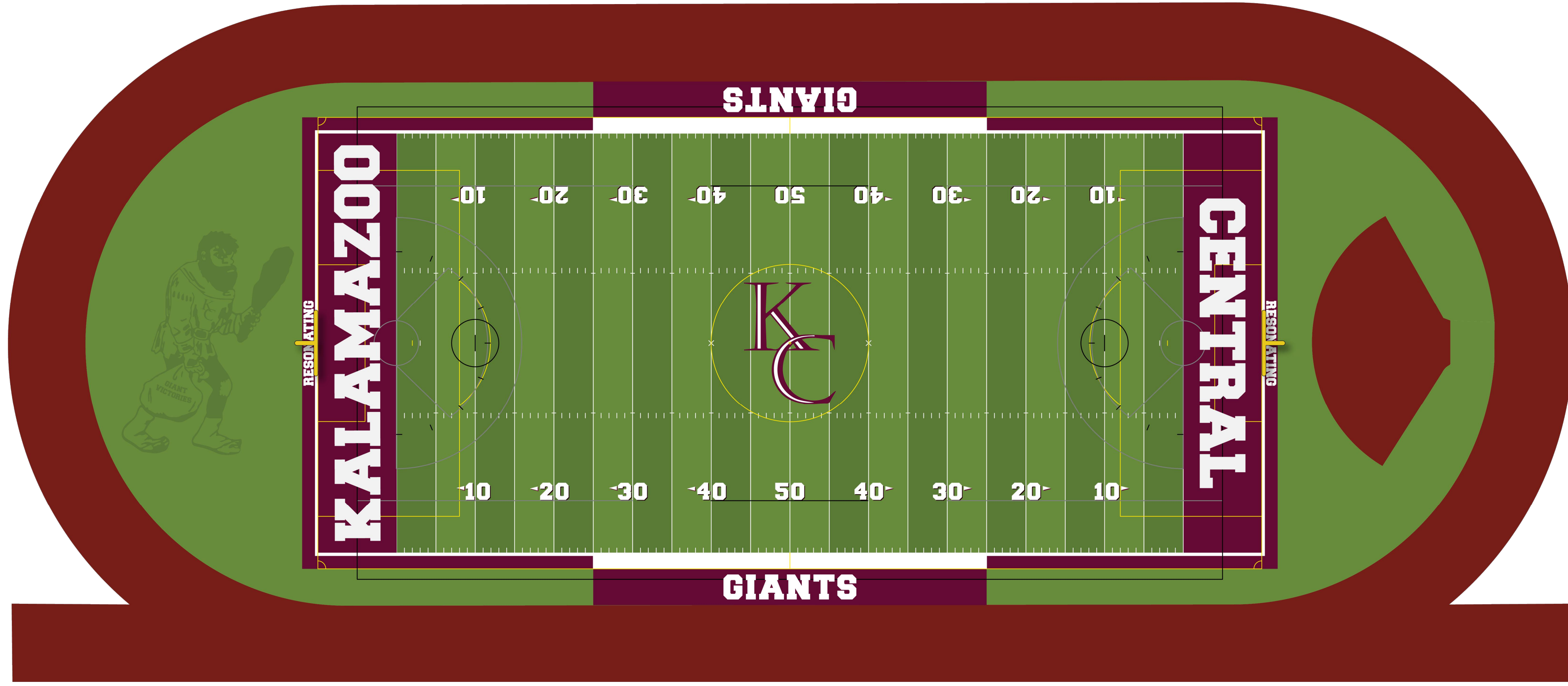

1 BASE BID TURF
REFERENCE GRAPHICS
N.T.S.

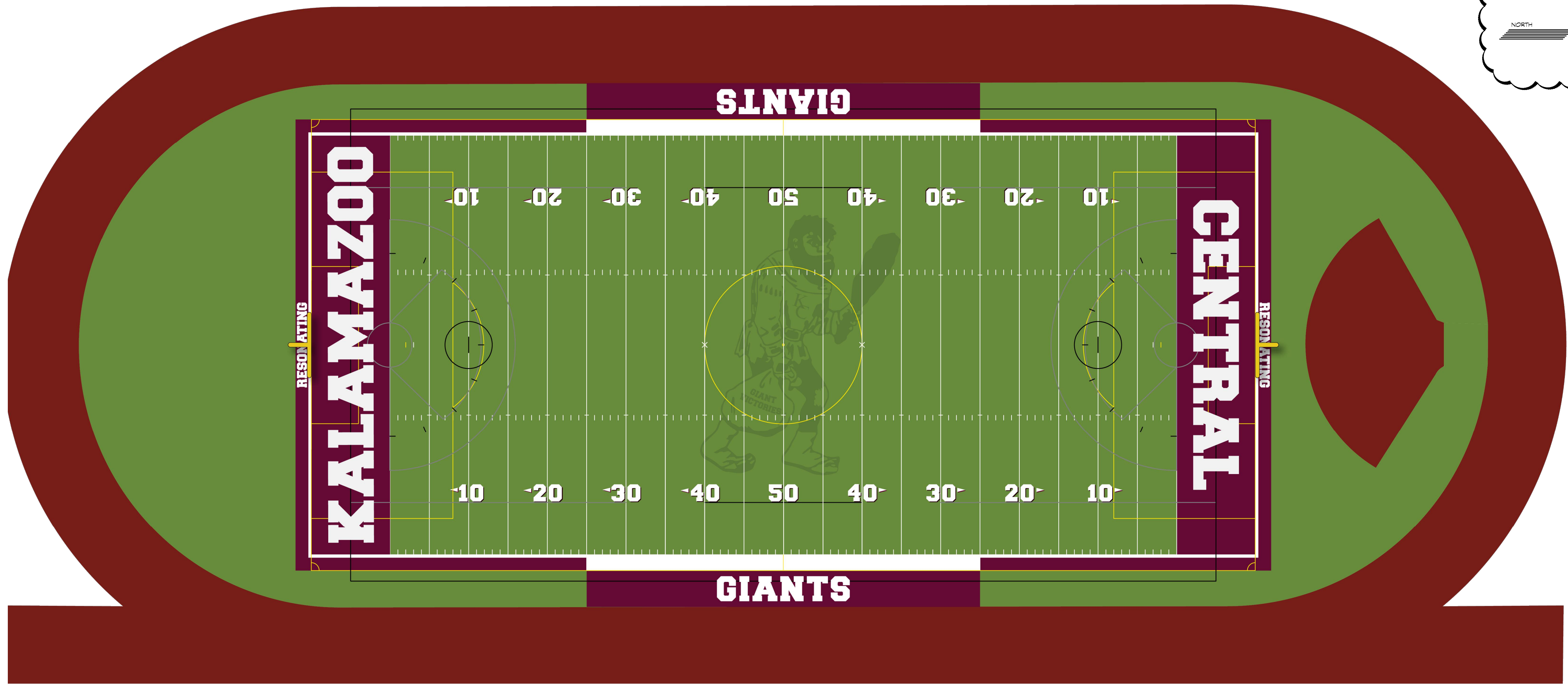

2 ALTERNATE BID TURF
REFERENCE GRAPHICS
N.T.S.

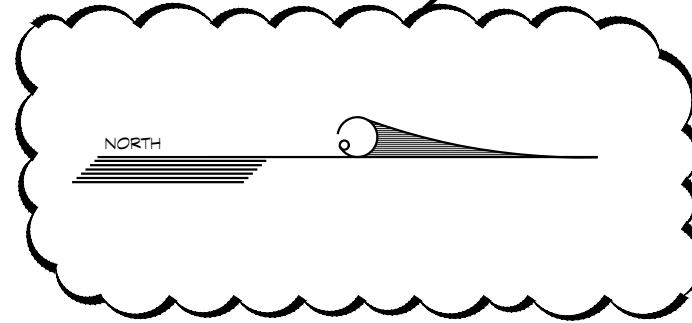

NOTES:
 1. THE ENCLOSED RENDERINGS ARE FOR REFERENCE PURPOSES ONLY.
 2. COLORS AND LAYOUTS SHOWN REPRESENT GRAPHICAL INTENT ONLY AND COLORS SHOWN SHALL NOT BE REGARDED AS ACTUAL COLORS OF INSTALLED PRODUCTS.
 3. MANUFACTURERS SHALL INCORPORATE STANDARD MANUFACTURER COLORS WITHIN PRODUCTION.
 4. DUE TO VARIATIONS IN MONITOR AND PRINTER SETTINGS WHEN VIEWING THESE REFERENCE SHEETS, THERE IS NO GUARANTEE THAT COLORS SHOWN WILL MATCH COLOR OF INSTALLED PRODUCT.



ADDENDUM No. 1 JANUARY 17, 2025
 ISSUED FOR DATE

PROJECT TITLE
 KALAMAZOO CENTRAL
 HIGH SCHOOL
 ATHLETICS
 PROJECT - BID
 PACKAGE 2

OWNER
 KALAMAZOO PUBLIC
 SCHOOLS
 Kalamazoo, Michigan

SHEET TITLE
 TURF GRAPHICS
 REFERENCE DETAILS

DATE
 DECEMBER 20, 2024

SHEET NUMBER
 L 512
 23-625.00

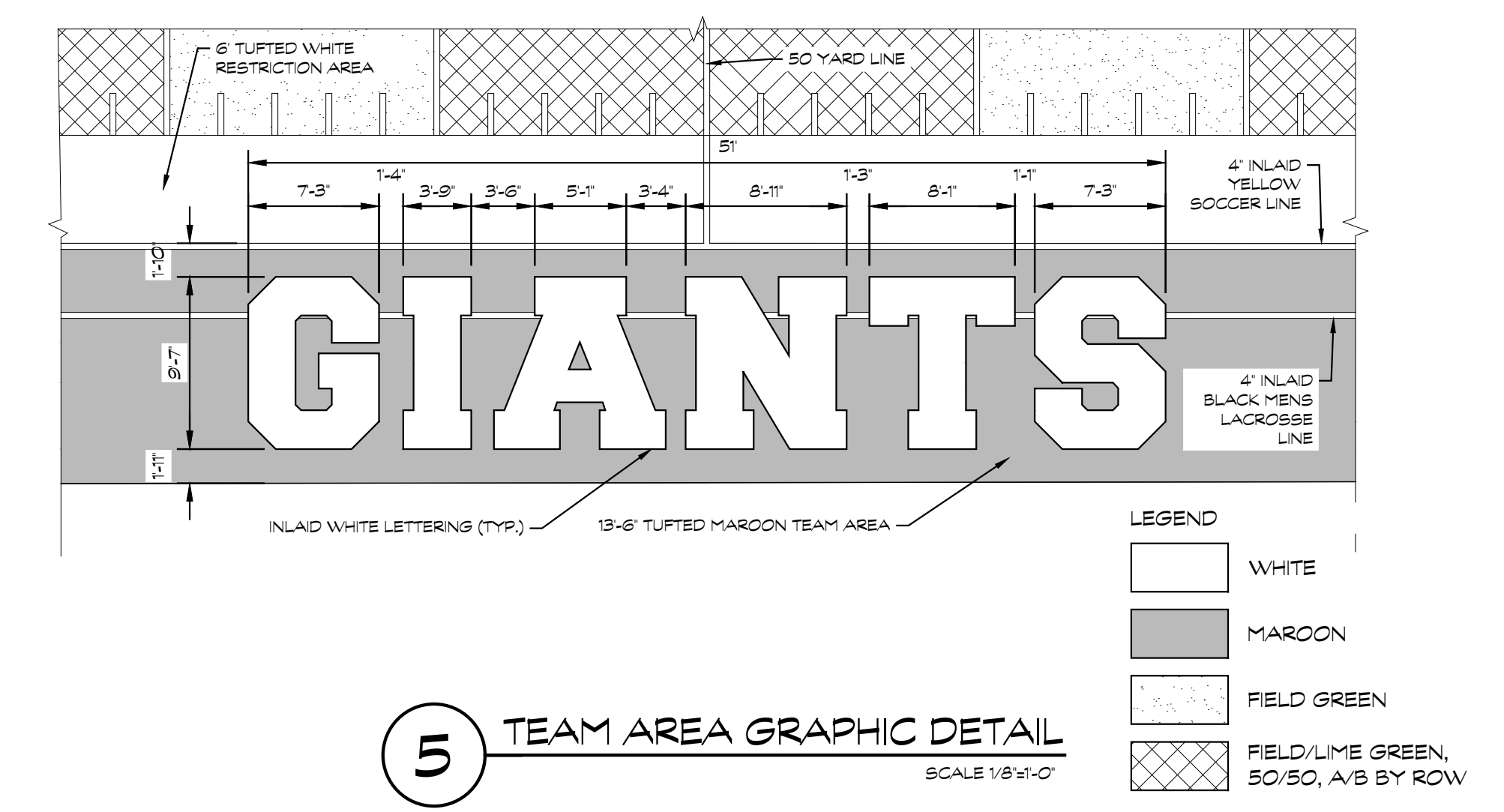
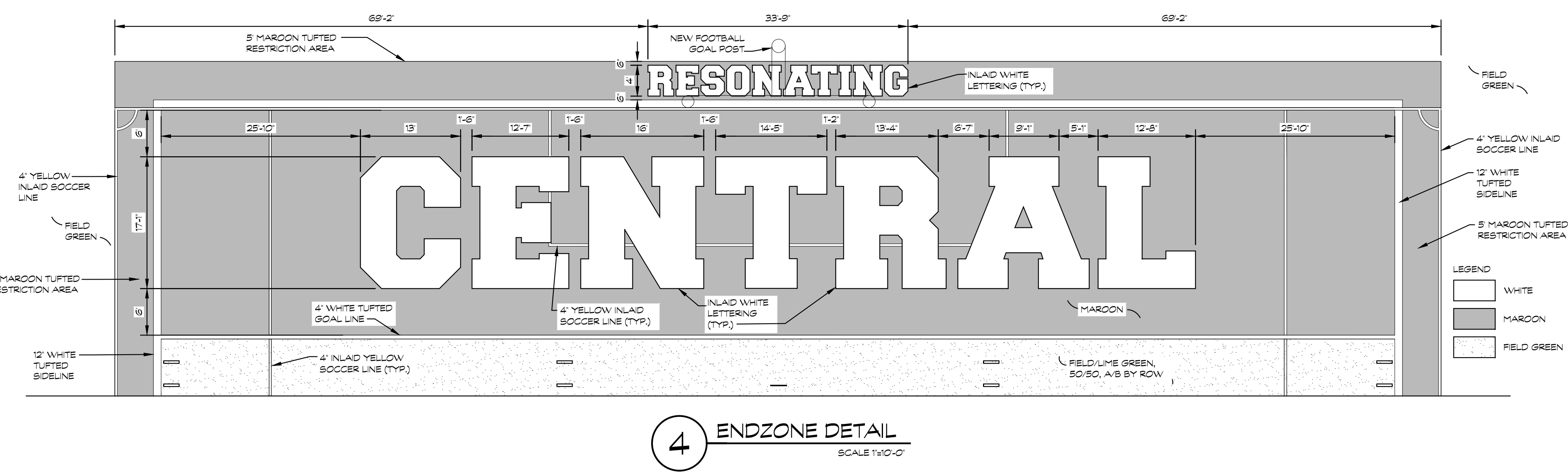
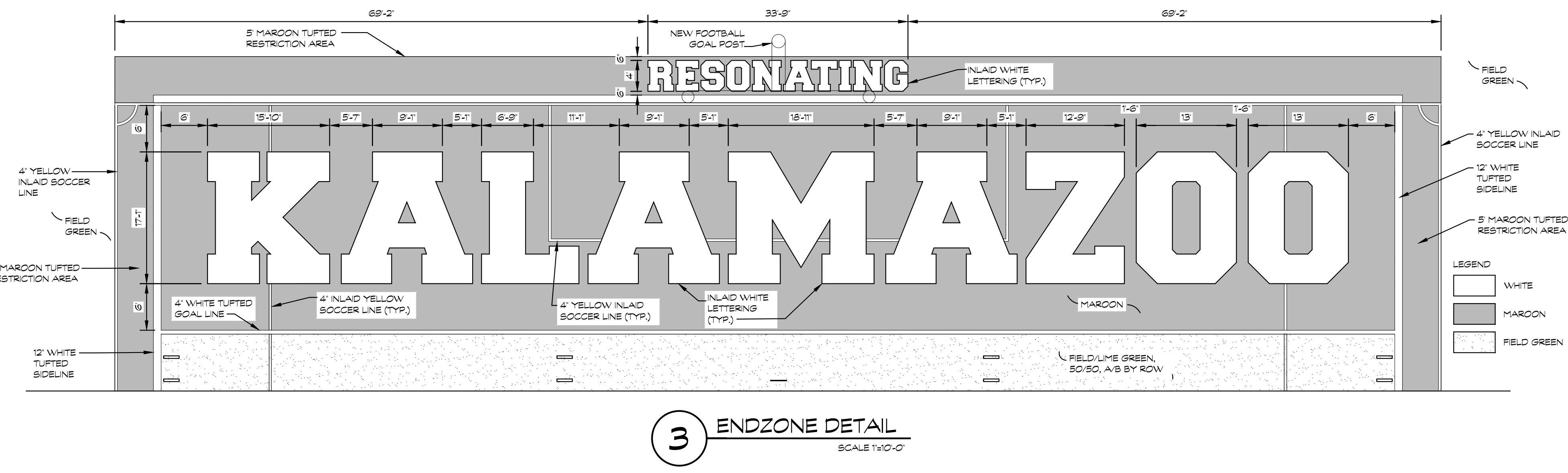
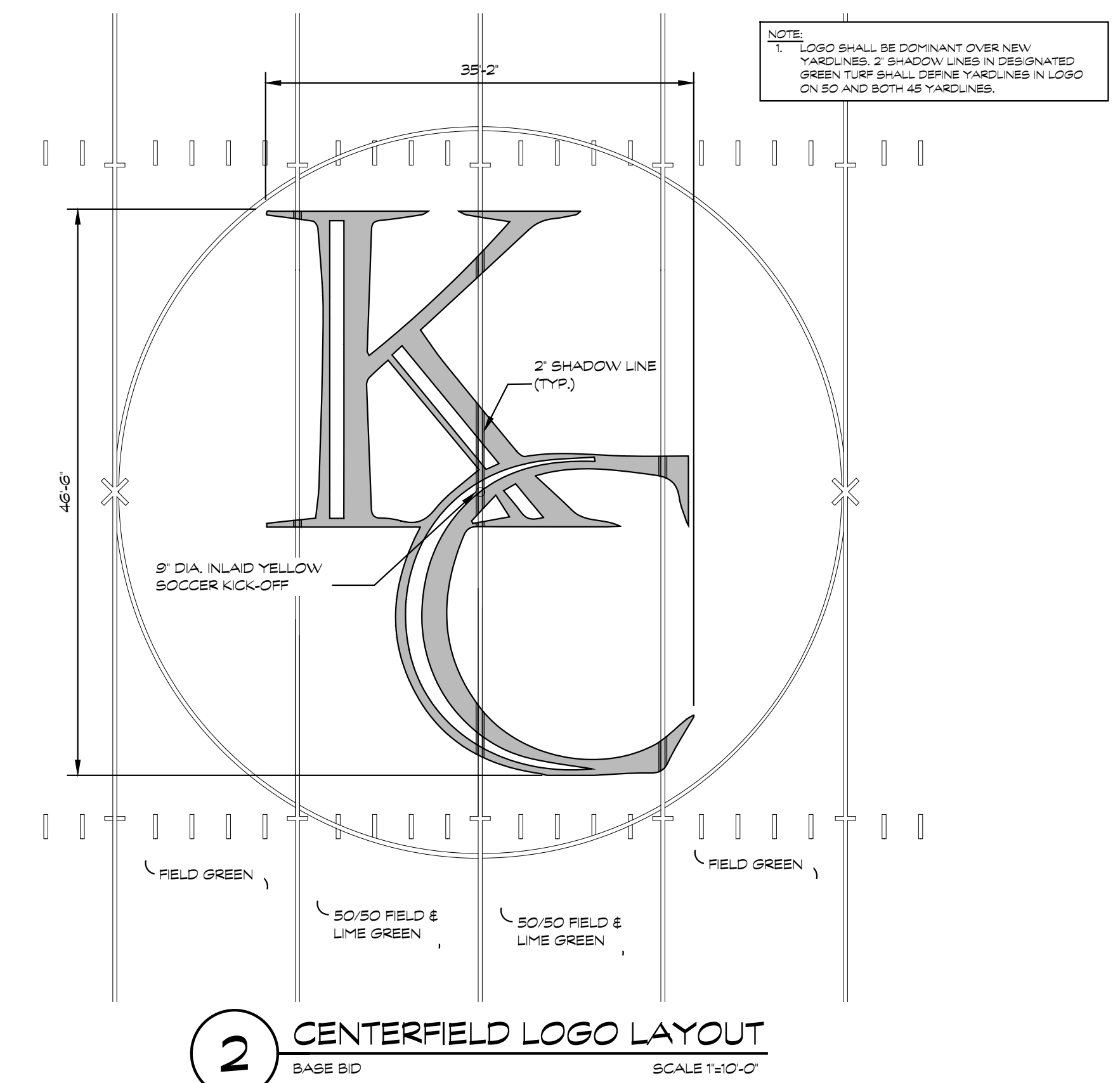
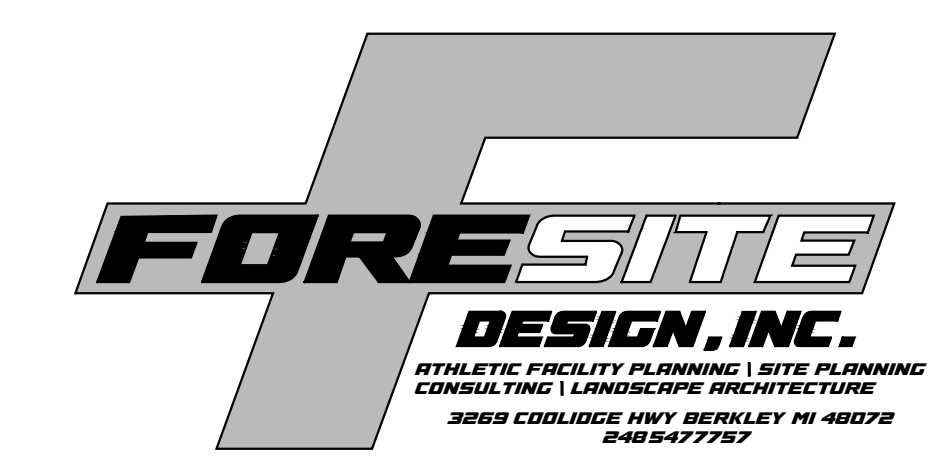
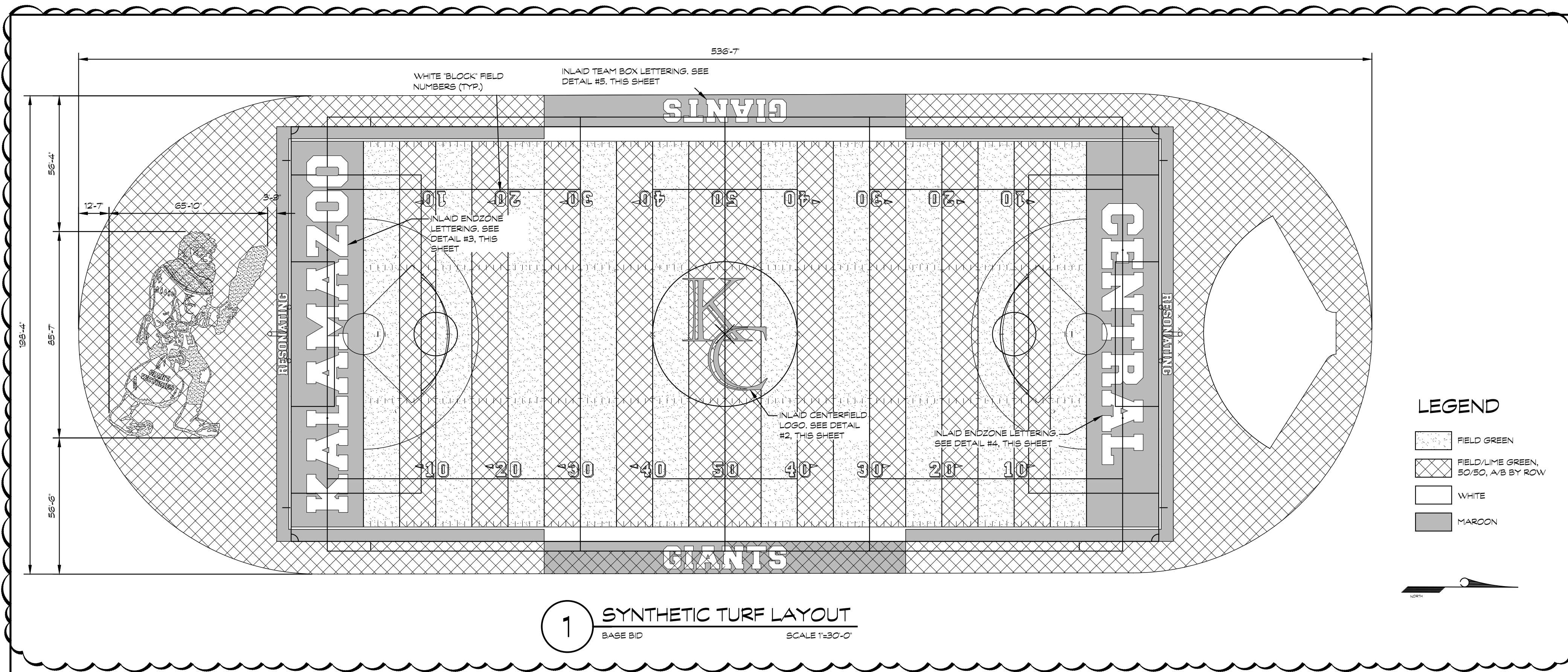

TowerPinkster
Architecture · Engineering · Interiors
TOWERPINKSTER.COM
© 2024. ALL RIGHTS RESERVED.

ADDENDUM No. 1 JANUARY 17, 2025
ISSUED FOR _____ DATE _____

PROJECT TITLE
KALAMAZOO CENTRAL
HIGH SCHOOL
ATHLETICS
PROJECT - BID
PACKAGE 2

OWNER
KALAMAZOO PUBLIC
SCHOOLS
Kalamazoo, Michigan

SHEET TITLE
FIELD GRAPHICS

SHEET NUMBER
L513.1
23-625.00

DATE
DECEMBER 20, 2024

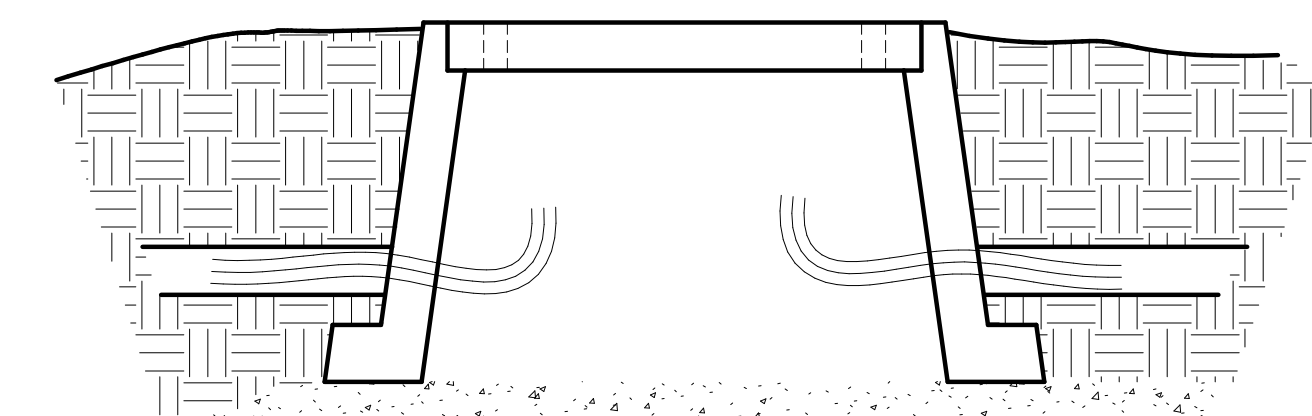

- ALL HAND HOLES SHALL BE QUAZITE BY HUBBELL
- LOCATIONS INDICATED ON DRAWINGS ARE DIAGRAMMATICAL. COORDINATE FINAL LOCATIONS WITH OWNER PRIOR TO INSTALLATION.
 - 12" x 12" PC1212BA12 OPEN BOTTOM
 - PC1212CA0012 COVERS W/ "COMMUNICATIONS" FOR ALL COMM HAND HOLES
 - PC1212CA0017 COVERS W/ "ELECTRIC" FOR ALL ELECTRICAL HAND HOLES.
 - 17" x 30" PD1730BA18 OPEN BOTTOM
 - PG1730HH0012 COVERS W/ "COMMUNICATIONS" FOR ALL COMM HAND HOLES
 - PG1730HH0017 COVERS W/ "ELECTRIC" FOR ALL ELECTRICAL HAND HOLES.

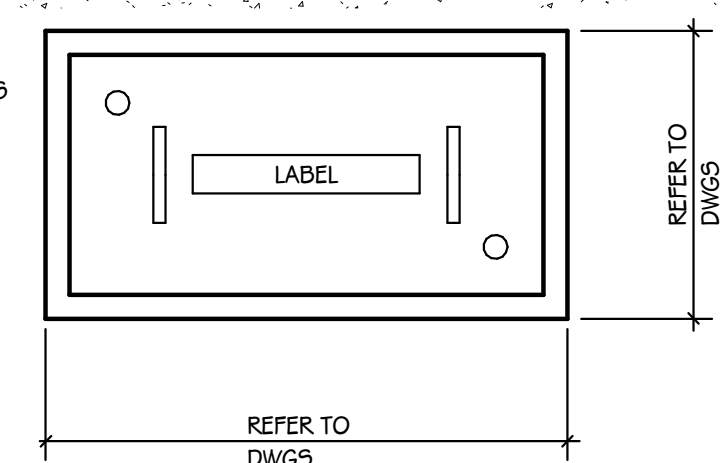

HAND HOLE DETAIL
SCALE: NONE

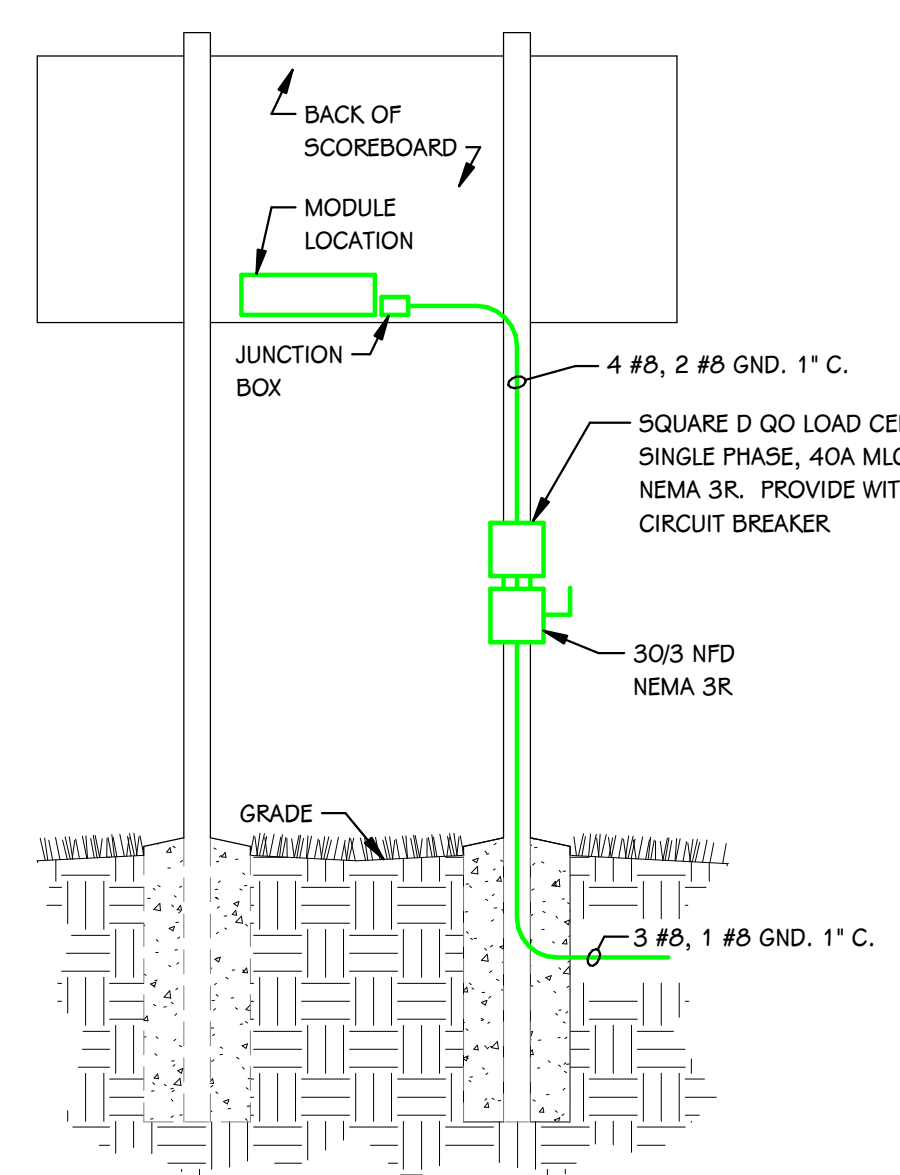

- 2" DATA CONDUIT W/ PULL ROPE UNLESS NOTED OTHERWISE.
- 1" POWER CONDUIT UNLESS NOTED OTHERWISE.

SCOREBOARD REAR ELEVATION
SCALE: NONE

ELECTRICAL - SITE - GENERAL NOTES

- WIRE UPSIZING IS NOTED WHERE APPROPRIATE TO ACCOMMODATE FOR VOLTAGE DROP. WIRE SIZES SHALL BE #10 UNLESS OTHERWISE NOTED.
- WIRE UPSIZING SHOWN IS ONLY ACCURATE FOR THE WIRING CONFIGURATION SHOWN. CONTRACTOR SHALL ENSURE THAT ALL VOLTAGE DROP REQUIREMENTS ARE MET IF WIRING CONFIGURATION CHANGES.
- PROVIDE TRENCHING AND DIRECTIONAL BORING AS REQUIRED FOR ALL ELECTRICAL SITE WORK. REFER TO SITE / CIVIL UTILITY PLAN, CALL MISS DIG, AND RADAR SITE PRIOR TO ANY SITE TRENCHING OR DIRECTIONAL BORING.
- ALL CONDUITS SHALL ENTER/EXIT THE BUILDING BELOW GRADE. CUT AND PATCH AS REQUIRED. NO EXPOSED CONDUIT SHALL BE ALLOWED.
- ALL CONDUITS FOR COMMUNICATIONS AND FUTURE POWER SHALL HAVE PULL STRING.
- COORDINATE ALL GROUND BOX LOCATIONS WITH OWNER'S ATHLETIC TEAM PRIOR TO INSTALLATION. COORDINATE ALL LOW VOLTAGE CONDUIT PATHWAYS WITH OWNERS TECHNOLOGY GROUP PRIOR TO INSTALLATION.
- COORDINATE ALL GROUND BOX LOCATIONS WITH SITE CIVIL TRENCH DRAINS. COORDINATE ALL CONDUIT PATHWAYS WITH SITE CIVIL UNDERDRAIN SYSTEM. ADJUST PATHWAYS, CONDUIT DEPTH, LOCATION OF GROUND BOXES IN FIELD AS REQUIRED. PROVIDE DETAILED AS-BUILT DRAWINGS.
- CONDUIT ROUTING SHOWN IN DIAGRAMMATICAL. MAINTAIN MINIMUM 12" SEPARATION BETWEEN LOW VOLTAGE CONDUIT AND LINE VOLTAGE CONDUITS.

ELECTRICAL - SITE - KEYED NOTES

- FOR EACH PRESS BOX, INTERCEPT EXISTING BANK OF 10 CONDUITS FOR POWER AND SOUND SYSTEM. CUT BACK, REWORK AS REQUIRED, AND EXTEND CONDUITS TO NEW PRESS BOX. PROVIDE ALL NEW WIRING BACK TO PANEL. NO SPLICES OR JUNCTION BOXES SHALL BE ALLOWED BETWEEN PANEL AND PRESS BOX.
- RECESS BACKBOX AND PROVIDE INTERMATIC LOW-PROFILE EXTRA-DUTY PLASTIC IN-LINE WEATHERPROOF COVER, SINGLE-GANG MODEL #WP7000X. COLOR TO MATCH PAINT. COORDINATE INSTALLATION WITH MASON.
- PROVIDE NEW 20A/1P BREAKER IN EXISTING PANELBOARD. STUB CONDUIT OUT OF BUILDING AT 24" ABOVE GRADE WITH LB, TRENCH OR DIRECTIONALLY BORE TO NEW BAND TOWER LOCATION. INSTALL RECEPTACLES ON BAND TOWER. COORDINATE FINAL LOCATION IN FIELD WITH OWNER PRIOR TO INSTALLATION. REFER TO DETAIL.
- REMOVE ELECTRICAL CONNECTION TO EXISTING SCOREBOARD ALONG WITH ALL ASSOCIATED CONDUIT AND WIRE BACK TO SOURCE. RETAIN ANY CODE COMPLIANT CONDUIT ENTERING / EXITING THE ELECTRICAL ROOM.
- REINSTALL EXISTING GROUND BOXES IN NEW TURF FIELD. RAISE TO NEW FIELD ELEVATION; REWORK CONDUIT AS REQUIRED.

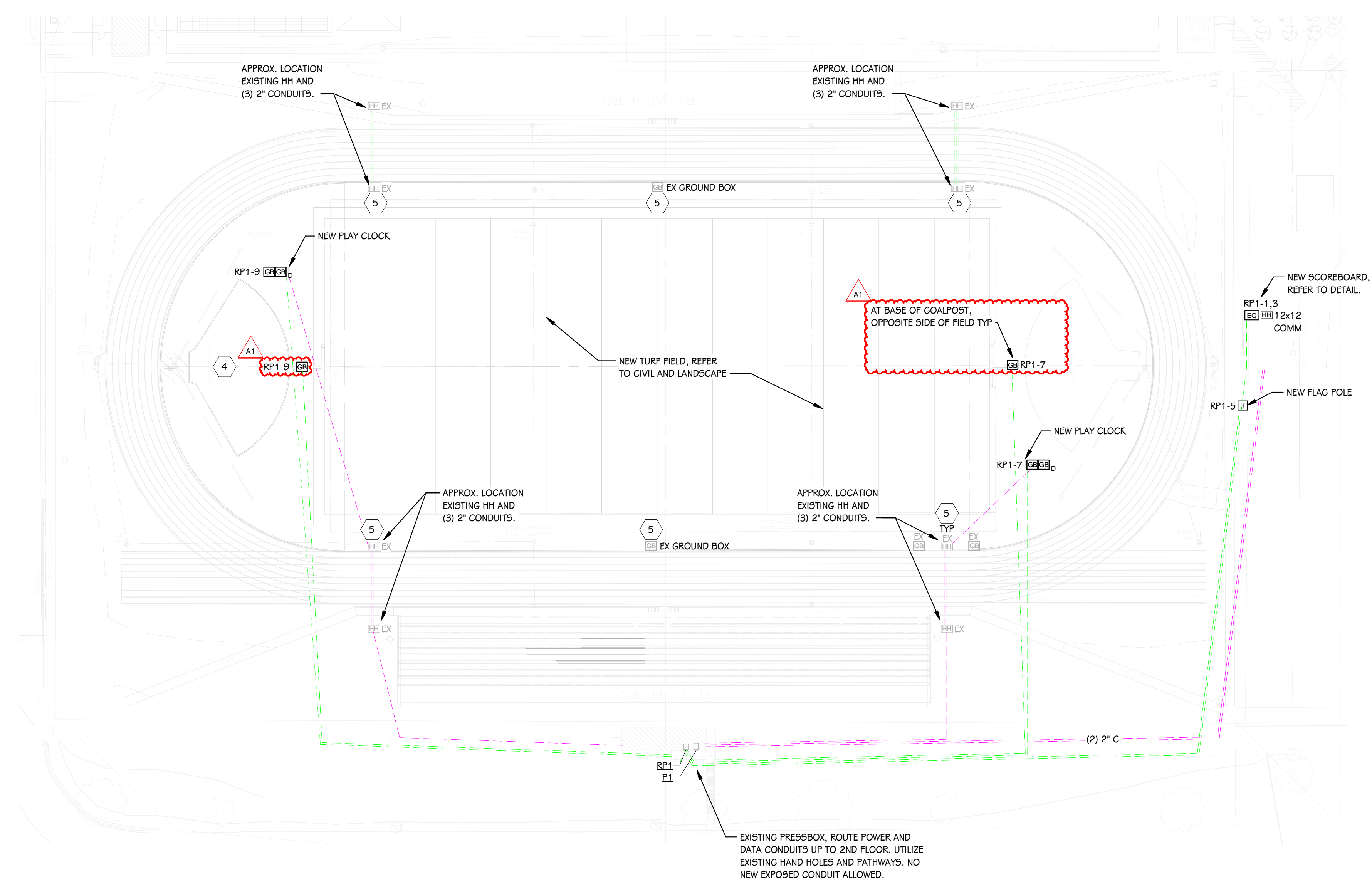

ELECTRICAL SITE PLAN - FOOTBALL FIELD
1" = 40'-0"

THIS DRAWING SHEET IS INTENDED TO BE PLOTTED IN COLOR. IF THIS TEXT APPEARS IN BLACK AND WHITE, IT IS PLOTTED INCORRECTLY. DISCARD AND OBTAIN AN ACCURATE DRAWING

ADDENDUM #1 01/17/2025
ISSUED FOR DATE

PROJECT TITLE
KALAMAZOO CENTRAL
HIGH SCHOOL
ATHLETICS PROJECT

OWNER
KALAMAZOO PUBLIC
SCHOOLS
Kalamazoo, Michigan

SHEET TITLE
ELECTRICAL SITE PLAN - FOOTBALL
FIELD
DATE
DECEMBER 20, 2024
SHEET NUMBER
ES 104
23623.00