

- SITE PLAN NOTES**
- SEE SHEET L 502 FOR LOCATIONS OF THE FOLLOWING PROPOSED ITEMS:  
 12' x 18' TURF BOX  
 6 x 12 CONCRETE TURF ANCHOR (TYP.)  
 GOAL POSTS  
 PLAY CLOCK  
 SCOREBOARD  
 FLAGPOLE

- UTILITY NOTES**
- ADJUST RIMS OF ALL EXISTING STRUCTURES WITHIN FOOTBALL FIELD IMPROVEMENTS TO BE MIN. 12" BELOW PROPOSED FINISHED GRADE. (SEE DETAIL #2, SHEET LD1.01.)
  - NEW FLAG POLE TO HAVE LIGHT, REFER TO ELECTRIC ENGINEER FOR ELECTRICAL SERVICE. SEE LOCATION SHEET L 505

**LEGEND**

	EXISTING PAVEMENT/ TRACK TO REMAIN
	PROPOSED SYNTHETIC TURF
	FURNISH AND INSTALL TRACK PROTECTION OVER EXISTING ASPHALT. TRACK PROTECTION SHALL BE LEFT ON SITE UNTIL WORK BY ALL TRADES IS COMPLETE.
	PROPOSED FOOTBALL/SOCCER FIELD STRIPING (SEE L PLAN SHEETS)
	NEW 1" x 12" FLATDRAIN AT 0.5% SLOPE (REFER TO SHEET L 505)
	NEW 8" PERFORATED DRAINTILE (REFER TO SHEET L 505)
	LIMITS OF FOOTBALL FIELD IMPROVEMENTS (SEE SHEETS L 501 - L 515)

- GENERAL NOTES**
- DIMENSIONS TAKE PRECEDENCE OVER SCALE. CONTRACTOR TO VERIFY ALL DIMENSIONS IN FIELD.
  - IF ANY ERRORS, DISCREPANCIES, OR OMISSIONS BECOME APPARENT, THESE SHALL BE BROUGHT TO THE ATTENTION OF THE ARCHITECT/ENGINEER PRIOR TO CONSTRUCTION OF ANYTHING AFFECTED SO THAT CLARIFICATION OR REDESIGN MAY OCCUR.
  - ALL CURB RADI AND DIMENSIONS ARE TO FACE OF CURB. CURB TO BE PROVIDED WHERE SHOWN AND INTEGRAL WITH SIDEWALK AT PAVING EDGE.
  - SLOPE GRADES UNIFORMLY BETWEEN ELEVATIONS SHOWN. NOMINAL GRADING, SLOPE SIDEWALKS AWAY FROM BUILDING AT 1/4" PER FOOT ON ENTRY WALK.

A: 3249 Coalinga Highway  
 Santa Ana, Michigan 48072  
 ☎ 248-547-7757  
 www.foresitedesign.com

CIVIL ENGINEERING & SURVEYING  
 MICHIGAN | INDIANA | ILLINOIS | OHIO  
 285.250.5591 PHONE | 866.989.0884 FAX  
 www.arengineeringllc.com

PROJECT NUMBER: 24183001\_KCHS

ALL UTILITIES AS SHOWN ARE APPROXIMATE LOCATIONS DERIVED FROM ACTUAL MEASUREMENTS AND AVAILABLE RECORDS. THEY SHOULD NOT BE INTERPRETED TO BE EXACT LOCATION NOR SHOULD IT BE ASSUMED THAT THEY ARE THE ONLY UTILITIES IN THE AREA. FIELD WORK PERFORMED BY: DRIESENGA & ASSOCIATES, INC.

ADDENDUM No. 2 JANUARY 24, 2025  
 ISSUED FOR DATE

PROJECT TITLE  
 KALAMAZOO CENTRAL  
 HIGH SCHOOL  
 ATHLETICS PROJECT

OWNER  
 KALAMAZOO PUBLIC  
 SCHOOLS  
 Kalamazoo, Michigan

SHEET TITLE  
 SITE LAYOUT - UTILITY PLAN  
 FOOTBALL FIELD

SHEET NUMBER  
 C 200  
 23623.00

DATE  
 DECEMBER 20, 2024

**GRADING NOTES**

1. ALL WORK SHALL CONFORM TO ALL LOCAL, STATE AND FEDERAL LAWS, RULES AND REGULATIONS IN FORCE AT TIME OF CONSTRUCTION.
2. THE GENERAL CONTRACTOR SHALL BE RESPONSIBLE FOR OBTAINING ALL PERMITS, PERMIT COSTS, TAP FEES, METER DEPOSITS, PERMANENT UTILITY APPLICATIONS, BONDS, AND OTHER FEES REQUIRED FOR PROPOSED WORK. THIS SHALL INCLUDE, BUT SHALL NOT BE LIMITED TO THOSE REQUIRED BY THE MICHIGAN DEPARTMENT OF TRANSPORTATION.
3. CONTACT MISS DIG "811" FOR LOCATION OF UNDERGROUND UTILITIES A MINIMUM OF 48 HOURS BEFORE COMMENCING EXCAVATION WORK. THIS DOES NOT RELIEVE THE CONTRACTOR OF THE RESPONSIBILITY OF NOTIFYING UTILITY OWNERS WHO ARE NOT PART OF THE "MISS DIG" ALERT SYSTEM. THE CONTRACTOR SHALL CONDUCT HIS OPERATIONS IN A MANNER AS TO ENSURE THAT THOSE UTILITIES NOT REQUIRING RELOCATION WILL NOT BE DISTURBED.
4. DEMOLISH & REMOVE ALL EXISTING SITE FEATURES AS REQUIRED.
5. MATCH EXISTING GRADES AROUND PERIMETER WITH SLOPES AS SHOWN.
6. ALL SPOT ELEVATIONS ARE TOP OF PAVEMENT GRADES AT EDGE OF METAL (EOM) UNLESS OTHERWISE NOTED.
7. ALL SOIL EROSION CONTROL MEASURES SHALL BE IN PLACE PRIOR TO MASS GRADING.
8. ALL EARTHWORK SHALL BE IN ACCORDANCE WITH THE TECHNICAL SPECIFICATIONS AND GEOTECHNICAL REPORT.
9. ALL EXISTING ELEVATIONS ARE TO BE VERIFIED AND ACCEPTED AS SHOWN PRIOR TO COMMENCEMENT OF WORK.
10. CONTRACTOR SHALL TAKE PRECAUTIONS TO AVOID TRACKING SOIL ONTO ADJACENT ROADWAYS. CONTRACTOR SHALL SWEEP IMMEDIATELY IF OCCURS.
11. ANY DISTURBED AREA WHICH WILL BE LEFT UNWORKED 15 DAYS OR LONGER MUST BE SEEDED TO ESTABLISH VEGETATION FOR TEMPORARY STABILIZATION. BASINS TO BE SEEDED AND MULCH BLANKETS APPLIED IMMEDIATELY TO PROVIDE A STABLE BASE AND AVOID EXCESSIVE EROSION.
12. CONTRACTOR TO MAINTAIN POSITIVE DRAINAGE DURING ALL EARTHWORK OPERATIONS.
13. TOPSOIL AND SEED ALL AREAS DISTURBED AND NOT OTHERWISE DEVELOPED. ALL WORK I.E. DEMOLITION AND REMOVALS, DRAINAGE WORK, STONE AND ASPHALT, FENCING, TRACK SURFACE, ETC. SHALL BE COMPLETED BY DATE AS NOTED IN CONTRACT DOCUMENTS. ALL LAWN AREAS SHALL SLOPE TO DRAINAGE STRUCTURES.
14. ALL CONTOURS AND SPOT GRADES REFER TO FINISH GRADE OF LAWN, ASPHALT, OR CONCRETE. DO NOT FACTOR IN THE ALL-WEATHER SURFACE OR ACRYLIC COATING DEPTH.
15. SEE DETAILED GRADING OF FOOTBALL FIELD IMPROVEMENTS, SHEET L 504.

**SOIL EROSION & SEDIMENT CONTROL NOTES**

1. ALL CONSTRUCTION METHODS SHALL BE DONE IN COMPLIANCE WITH MDOT-EGLE. THE OWNER SHALL BE RESPONSIBLE FOR OBTAINING A "SOIL EROSION PERMIT" FROM THE GOVERNING AUTHORITY AND A "PERMIT BY RULE/NOTICE OF COVERAGE" FROM THE GOVERNING AUTHORITY. IF APPLICABLE, PRIOR TO START OF CONSTRUCTION, THE CONTRACTOR SHALL BE RESPONSIBLE FOR COMPLYING WITH ALL REQUIREMENTS OF THE "SOIL EROSION PERMIT" AND FOR ALL CERTIFIED STORM WATER INSPECTION SERVICE REQUIRED BY THE "PERMIT BY RULE." EROSION CONTROL MEASURES SHOWN ON THE PLANS ARE THE MINIMUM REQUIREMENTS AND SHALL NOT RELIEVE THE CONTRACTOR'S RESPONSIBILITY FOR PROVIDING ALL REQUIRED EROSION CONTROL MEASURES.
  2. AVOID UNNECESSARY DISTURBING OR REMOVING OF EXISTING VEGETATED TOPSOIL OR EARTH COVER. THESE COVER AREAS ACT AS SEDIMENT FILTERS.
  3. ALL TEMPORARY SOIL EROSION PROTECTION SHALL REMAIN IN PLACE UNTIL REMOVAL IS REQUIRED FOR FINAL CLEAN UP AND APPROVAL.
  4. GEOTEXTILE SILT FENCE SHALL BE INSTALLED AS REQUIRED WHEN CROSSING CREEKS OR WHEN ADJACENT TO WETLANDS OR SURFACE WATER BODIES TO PREVENT SILTATION AND ELSEWHERE AS DIRECTED BY THE ENGINEER. SEEDING AND/OR SODDING SHALL BE INSTALLED ON CREEK BANKS IMMEDIATELY AFTER CONSTRUCTION TO PREVENT EROSION.
  5. MAINTENANCE, CLEANING, AND REMOVAL OF THE VARIOUS SEDIMENT CONTROL MEASURES SHALL BE INCLUDED IN THE VARIOUS EROSION CONTROL ITEMS.
- ALL SOIL EROSION AND SEDIMENTATION CONTROL MEASURES SHALL BE PER MDOT STANDARD DETAILS. "P" DENOTES PERMANENT MEASURE AND "T" DENOTES TEMPORARY MEASURE. SOIL EROSION CONTROL PLANS DENOTE MINIMUM EROSION MEASURES REQUIRED AS DESCRIBED BELOW.
- DENOTES DUST CONTROL. DUST CONTROL MAY BE REQUIRED ON THE SUBGRADE CONSTRUCTION AND WILL INCLUDE APPLYING FRESH WATER TO BE INCLUDED IN THE ITEM OF EMBANKMENT. DUST CONTROL ON THE AGGREGATE BASE COURSE WILL BE ACCOMPLISHED BY APPLYING FRESH WATER (INCLUDED IN THE ITEM OF AGGREGATE BASE, 6 INCH) AND APPLYING DUST PALLIATIVE, APPLIED, CAC<sub>2</sub>, (TON) AS DIRECTED BY THE PROJECT ENGINEER.
- DENOTES AGGREGATE COVER/PERMANENT PAVEMENT RESTORATION
- DENOTES GRAVEL ACCESS APPROACH. APPROACH SHALL BE INSTALLED TO PROVIDE STABLE ACCESS TO ROADWAYS AND MINIMIZE DUST AND TRACKING OF MATERIALS ONTO PUBLIC STREETS AND HIGHWAYS. THE APPROACH SHALL BE A MINIMUM OF 12' WIDE, 6" DEEP, AND CONSIST OF 2" 4" AGGREGATE.
- DENOTES INLET PROTECTION FABRIC DROP. SHALL BE INSTALLED AT EXISTING AND PROPOSED STORM SEWER INLETS TO PROVIDE SETTLING AND FILTERING OF SILT LADEN WATER PRIOR TO ENTRY INTO THE DRAINAGE SYSTEM.
- DENOTES PERMANENT SEEDING. ALL DISTURBED AREAS NOT PAVED OR GRAVELED SHALL BE RESTORED. PLACE TOPSOIL SURFACE, SALV, 3 INCH, MDOT SEEDING, MIXTURE TUF APPLIED AT A RATE OF 220 LB/ACRE, FERTILIZER, CHEMICAL NUTRIENT, CL A APPLIED AT A RATE OF 228 LB/ACRE, MULCH AT A RATE OF 2 TON/ACRE AND MULCH ANCHORING. (APPLIES TO ENTIRE PROJECT)

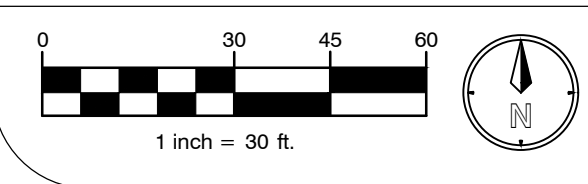
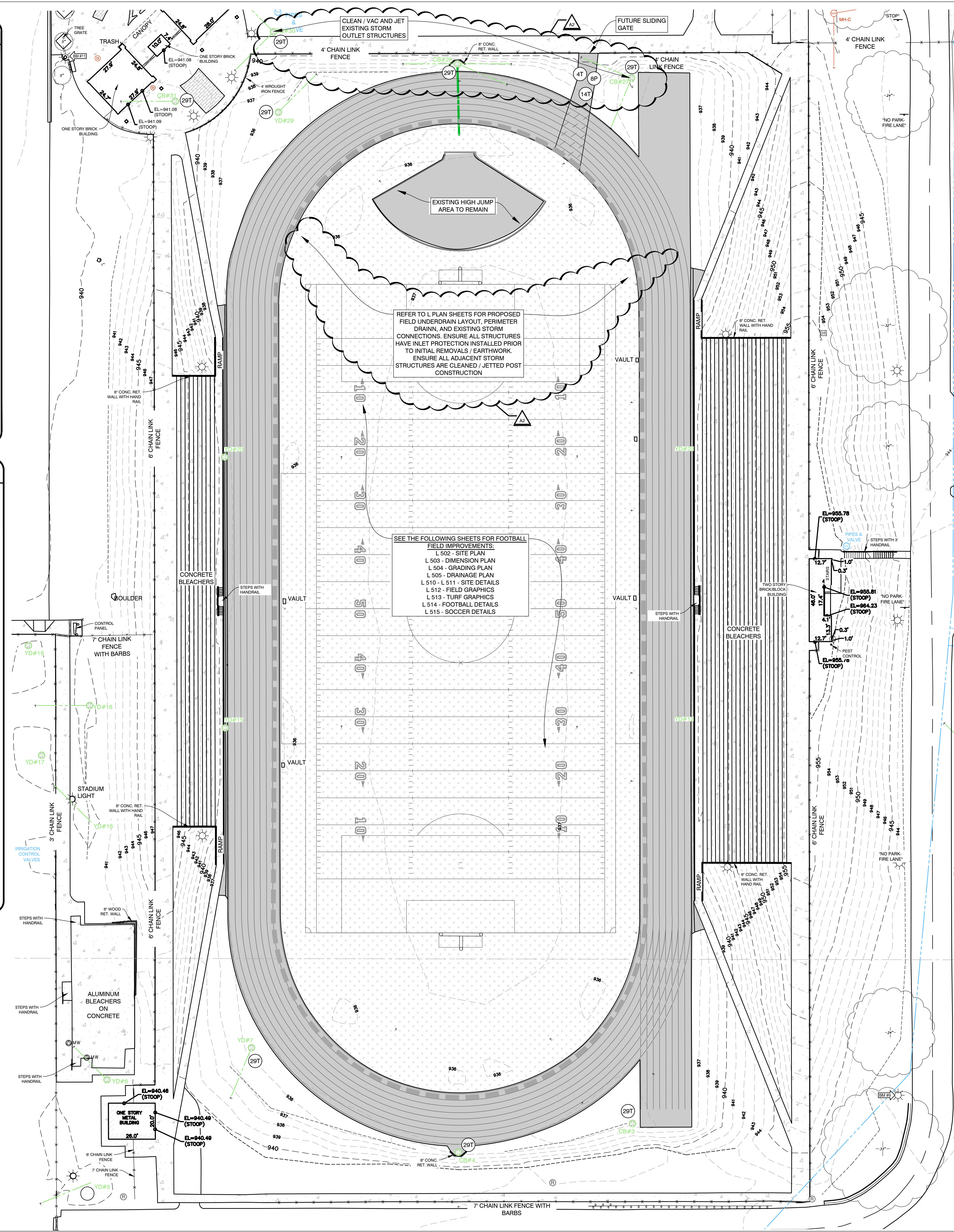

**SITE PLAN NOTES**

1. SEE SHEET L 502 FOR LOCATIONS OF THE FOLLOWING PROPOSED ITEMS:  
12' x 18' TURF BOX  
6 x 12 CONCRETE TURF ANCHOR (TYP.)  
GOAL POSTS  
PLAY CLOCK  
SCOREBOARD  
FLAGPOLE

**UTILITY NOTES**

1. ADJUST RIMS OF ALL EXISTING STRUCTURES WITHIN FOOTBALL FIELD IMPROVEMENTS TO BE MIN. 12" BELOW PROPOSED FINISHED GRADE. (SEE DETAIL #2, SHEET LD1.01.)
2. NEW FLAG POLE TO HAVE LIGHT. REFER TO ELECTRIC ENGINEER FOR ELECTRICAL SERVICE. SEE LOCATION SHEET L 505

**LEGEND**

- EXISTING PAVEMENT/ TRACK TO REMAIN
- PROPOSED SYNTHETIC TURF
- FURNISH AND INSTALL TRACK PROTECTION OVER EXISTING ASPHALT. TRACK PROTECTION SHALL BE LEFT ONSITE UNTIL WORK BY ALL TRADES IS COMPLETE.
- PROPOSED FOOTBALL/SOCCER FIELD STRIPING (SEE L PLAN SHEETS)
- NEW 1" x 12" FLATDRAIN AT 0.5% SLOPE (REFER TO SHEET L 505)
- NEW 8" PERFORATED DRAINTILE (REFER TO SHEET L 505)
- LIMITS OF FOOTBALL FIELD IMPROVEMENTS (SEE SHEETS L 501 - L 515)

**GENERAL NOTES**

1. DIMENSIONS TAKE PRECEDENCE OVER SCALE. CONTRACTOR TO VERIFY ALL DIMENSIONS IN FIELD.
2. IF ANY ERRORS, DISCREPANCIES, OR OMISSIONS BECOME APPARENT, THESE SHALL BE BROUGHT TO THE ATTENTION OF THE ARCHITECT/ENGINEER PRIOR TO CONSTRUCTION OF ANYTHING AFFECTED SO THAT CLARIFICATION OR REDESIGN MAY OCCUR.
3. ALL CURB RADI AND DIMENSIONS ARE TO FACE OF CURB. CURB TO BE PROVIDED WHERE SHOWN AND INTEGRAL WITH SIDEWALK AT PAVING EDGE.
4. SLOPE GRADES UNIFORMLY BETWEEN ELEVATIONS SHOWN. NOMINAL GRADING, SLOPE SIDEWALKS AWAY FROM BUILDING AT 1/4" PER FOOT ON ENTRY WALK.

ADDENDUM No. 2 JANUARY 24, 2025  
ISSUED FOR DATE

PROJECT TITLE  
**KALAMAZOO CENTRAL  
HIGH SCHOOL  
ATHLETICS PROJECT**

OWNER  
**KALAMAZOO PUBLIC  
SCHOOLS**  
  
Kalamazoo, Michigan



PROJECT NUMBER: 24183001\_KCHS



ALL UTILITIES AS SHOWN ARE APPROXIMATE LOCATIONS DERIVED FROM ACTUAL MEASUREMENTS AND AVAILABLE RECORDS. THEY SHOULD NOT BE INTERPRETED TO BE EXACT LOCATION NOR SHOULD IT BE ASSUMED THAT THEY ARE THE ONLY UTILITIES IN THE AREA. FIELD WORK PERFORMED BY: DRIESENGA & ASSOCIATES, INC.

SHEET TITLE  
**GRADING - SESC PLAN  
FOOTBALL FIELD**

DATE  
**DECEMBER 20, 2024**

SHEET NUMBER  
**C 300**  
23623.00

### LEGEND

EXISTING	PROPOSED
SPOT ELEVATION	SPOT GRADE
AS-BUILT SPOT ELEVATION	TOP OF WALL ELEVATION
FENCE	TOP OF CURB ELEVATION
DRAINAGE STRUCTURE	MATCH EXISTING ELEVATION
STORM DRAIN	TOP OF TRENCH ELEVATION
LIGHT POLE	DRAINAGE SWALE
ELECTRICAL	CHAINLINK FENCE - SEE PLANS FOR HT.
WATER	ORNAMENTAL FENCE - SEE PLANS FOR HT.
TELEPHONE	DRAINAGE STRUCTURE
IRRIGATION	STORM DRAIN
PROPERTY	FLAT DRAIN
SANITARY	4" PERFORATED DRAINTILE
GAS	6" PERFORATED DRAINTILE
	8" PERFORATED DRAINTILE
	LIGHT POLE
	ELECTRICAL
	WATER
	TELEPHONE
	IRRIGATION
	LIMITS OF CONSTRUCTION

- ### DEMOLITION NOTES:
- CONTRACTOR SHALL POWERFLUSH ALL EXISTING DRAIN LINES AND CLEAN DEBRIS FROM SUMPS WITHIN LIMITS OF CONSTRUCTION. FIELD VERIFY THAT ALL EXISTING DRAIN LINES ARE FUNCTIONAL AND CONNECTED.
  - CONTRACTOR SHALL VERIFY LOCATIONS OF ALL ON-SITE UTILITIES PRIOR TO CONSTRUCTION ON THE CONTRACTOR'S BEHALF. WORK SHALL INCLUDE ENLISTING THE SERVICES OF A PRIVATE UTILITY LOCATOR AS REQUIRED.
  - ANY DEPRESSIONS CREATED DURING DEMOLITION ACTIVITIES SHALL BE BACKFILLED WITH CLASS II FILL MATERIAL UP TO PROPOSED SUBGRADE ELEVATION, IN 8 INCH LIFTS AND COMPACTED TO 95% OF MAXIMUM UNIT WEIGHT.
  - ALL CONTRACTORS ARE RESPONSIBLE TO PROTECT EXISTING WALKS, PAVEMENT, LAWNS, BUILDINGS, AND TREES SCHEDULED TO REMAIN THROUGH CONSTRUCTION.
  - ALL EXCESS SOIL SHALL BE EXPORTED OFFSITE UNLESS NOTED OTHERWISE

- ### DEMOLITION LEGEND:
- FURNISH AND INSTALL PROTECTION OVER EXISTING TRACK. PROTECTION SHALL BE LEFT ONSITE UNTIL WORK BY ALL TRADES IS COMPLETE.
  - REMOVE EXISTING IRRIGATION SYSTEM VALVES, LATERAL LINES AND HEADS, MAINLINE IN FIELD TO REMAIN.
  - STRIP TOPSOIL AND SPOILS, TRUCK TO LOCATION NOTED ON SITE. ALL EXCESS SOIL SHALL BE EXPORTED OFFSITE UNLESS NOTED OTHERWISE. MAINTAIN POSITIVE DRAINAGE DURING ALL EARTHWORK OPERATIONS.
  - LOCATE, POWER WASH, AND CLEAN SUMPS OF ALL EXISTING CATCH BASINS AND STORM DRAIN AROUND THE PERIMETER OF THE STADIUM. CONTRACTOR SHALL ENSURE DRAINAGE SYSTEM HAS POSITIVE FLOW.
  - REMOVE AND DISPOSE EXISTING FOOTBALL GOAL POSTS, FLAG POLE, AND FOOTINGS. REFER TO ELECTRICAL FOR SCOREBOARD DEMOLITION. PARTIALLY REMOVE EXISTING CONCRETE FOOTINGS TO MIN. 12" BELOW FINISH GRADE. CONTRACTOR SHALL BACKFILL AND TAMP HOLES FROM FOOTING REMOVAL.
  - SAWCUT EXISTING ASPHALT EDGE OF TRACK, FIELD VERIFY LIMITS WITH ARCHITECT PRIOR TO SAWCUTTING OPERATIONS (41588LP).
  - REMOVE EXISTING CHAINLINK FABRIC, POSTS, RAILS, HARDWARE, AND FOOTINGS, BACKFILL AND TAMP HOLES FROM FOOTING REMOVAL.
  - REMOVE AND REPLACE EXISTING DRAINTILE CONNECTION IN FIELD TO NEW 8" COLLECTOR LINE.
  - CUT EXISTING DRAIN LINE, FILL WITH FLOWABLE FILL AND ABANDON IN PLACE.

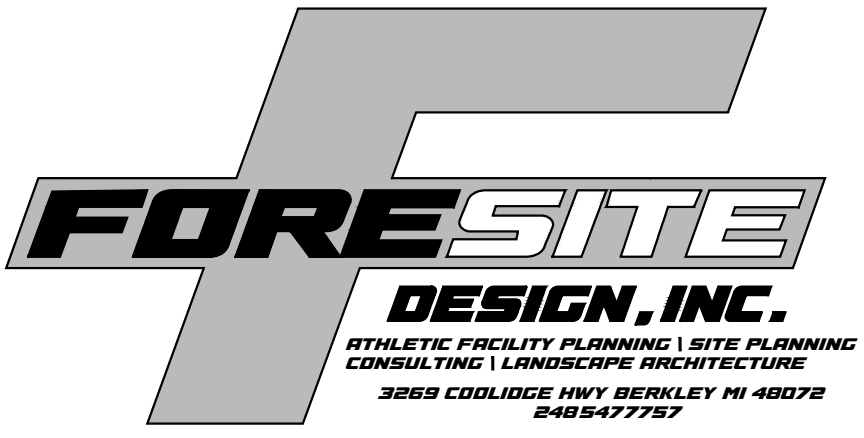

- NOTES AND LEGEND SHALL APPLY TO ALL SHEETS AND ALL SITES
- CONTRACTOR SHALL BE SOLELY RESPONSIBLE AND MAKE EVERY EFFORT TO LOCATE EXISTING UNDERGROUND UTILITIES. THIS SHALL INCLUDE CONSULTING WITH ALL LOCAL UTILITY COMPANIES AND USING A SIGNAL LOCATOR PRIOR TO EXCAVATION. ANY AND ALL REPAIRS SHALL BE COMPLETED WITHIN 48 HRS. OR THE OWNER SHALL HAVE THE REPAIR WORK COMPLETED AT THE CONTRACTOR'S EXPENSE.
- TOPSOIL AND SEED ALL AREAS DISTURBED AND NOT OTHERWISE DEVELOPED. ALL WORK (IE DEMOLITION AND REMOVALS, DRAINAGE WORK, STONE AND ASPHALT, FENCING, TRACK SURFACE, ETC.) SHALL BE COMPLETED BY DATE AS NOTED IN CONTRACT DOCUMENTS. ALL LAWN AREAS SHALL SLOPE TO DRAINAGE STRUCTURES.
- ALL CONTOURS AND SPOT GRADES REFER TO FINISH GRADE OF LAWN, ASPHALT, OR CONCRETE. DO NOT FACTOR IN THE ALL-WEATHER SURFACE OR ACRYLIC COATING DEPTH.

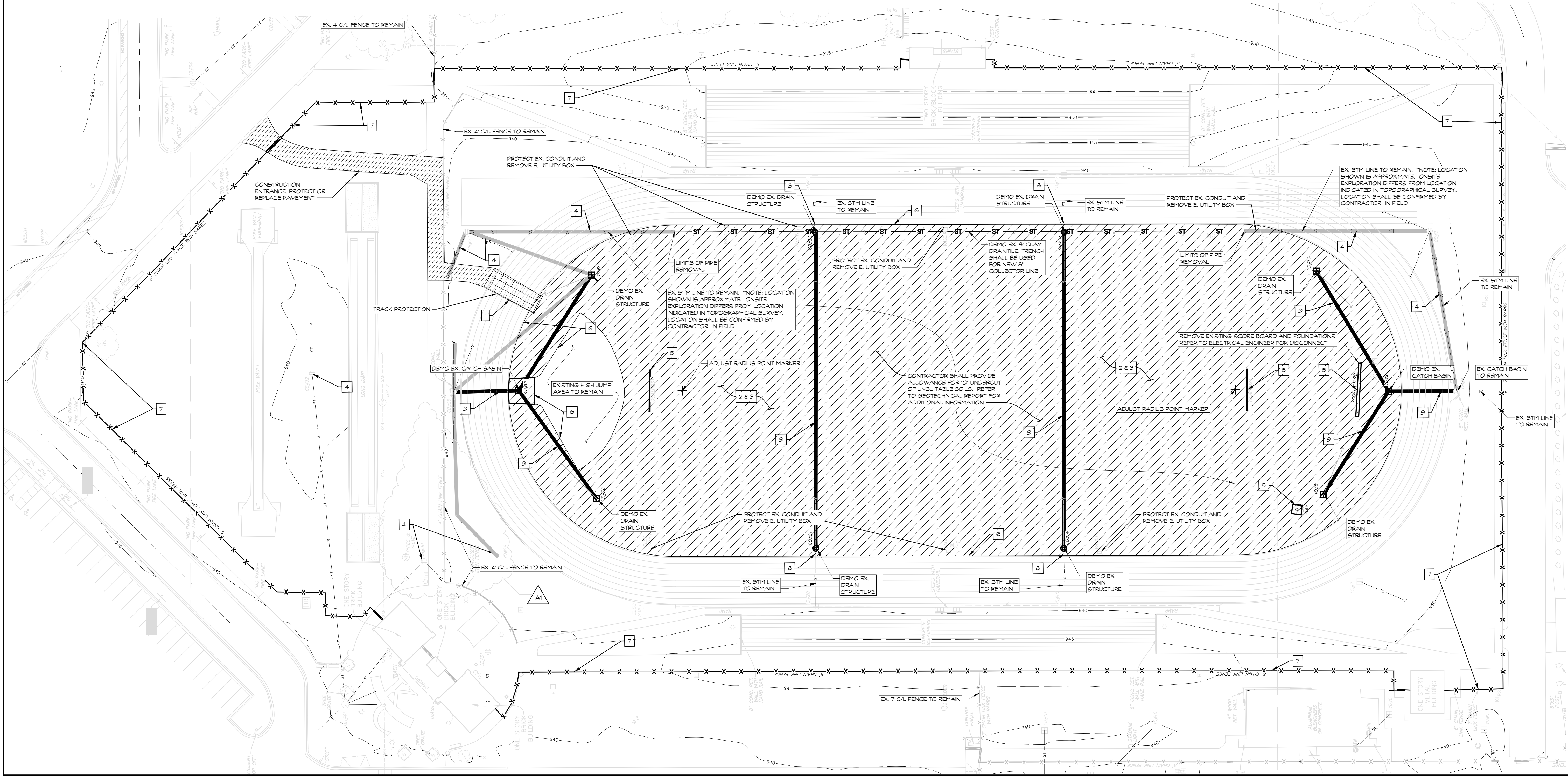

ADDENDUM No. 2 JANUARY 24, 2025  
ADDENDUM No. 1 JANUARY 17, 2025  
ISSUED FOR \_\_\_\_\_ DATE \_\_\_\_\_

PROJECT TITLE  
KALAMAZOO CENTRAL  
HIGH SCHOOL  
ATHLETICS  
PROJECT - BID  
PACKAGE 2

OWNER  
KALAMAZOO PUBLIC  
SCHOOLS  
Kalamazoo, Michigan

SHEET TITLE  
DEMOLITION PLAN

DATE  
DECEMBER 20, 2024

SHEET NUMBER  
L501  
23-625.00

### LEGEND

EXISTING	PROPOSED
SPOT ELEVATION	SPOT GRADE
AS-BUILT SPOT ELEVATION	TOP OF WALL ELEVATION
FENCE	TOP OF CURB ELEVATION
DRAINAGE STRUCTURE	MATCH EXISTING ELEVATION
STORM DRAIN	TOP OF TRENCH ELEVATION
LIGHT POLE	DRAINAGE SWALE
ELECTRICAL	CHAINLINK FENCE - SEE PLANS FOR HT.
WATER	ORNAMENTAL FENCE - SEE PLANS FOR HT.
TELEPHONE	DRAINAGE STRUCTURE
IRRIGATION	STORM DRAIN
PROPERTY	FLAT DRAIN
SANITARY	4" PERFORATED DRAINTILE
GAS	6" PERFORATED DRAINTILE
	8" PERFORATED DRAINTILE
	LIGHT POLE
	ELECTRICAL
	WATER
	TELEPHONE
	IRRIGATION
	LIMITS OF CONSTRUCTION

### STADIUM UTILITY LEGEND:

- 1 NEW 8" COLLECTOR PIPE AT 0.3% SLOPE ON INTERIOR OF TRACK
- 2 FIELD CONNECT EXISTING DRAINTILE TO NEW 8" COLLECTOR PIPE
- 3 NEW 1" X 12" FLAT DRAIN AT 0.3% SLOPE
- 4 NEW 2' CATCH BASIN WITH RIM MIN. 12" BELOW PROPOSED FINISH GRADE. SEE DETAIL #2, SHEET L510. FIELD CONNECT NEW 8" PERFORATED COLLECTOR TO STRUCTURE. REMOVE AND REPLACE EXISTING DRAINTILE CONNECTIONS IN FIELD. SEE DETAIL #4, SHEET L510
- 5 NEW 18" X 30" PRE-MANUFACTURED TURF GROUND BOX FOR EXISTING POWER/DATA.

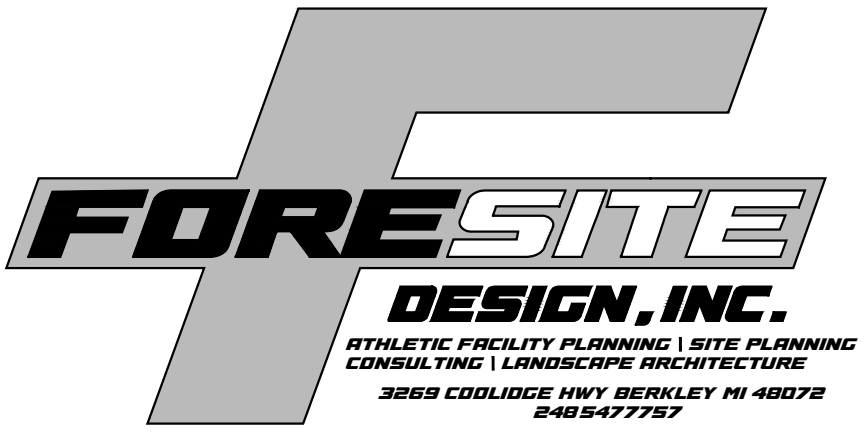

1. NOTES AND LEGEND SHALL APPLY TO ALL SHEETS AND ALL SITES
2. CONTRACTOR SHALL BE SOLELY RESPONSIBLE AND MAKE EVERY EFFORT TO LOCATE EXISTING UNDERGROUND UTILITIES. THIS SHALL INCLUDE CONSULTING WITH ALL LOCAL UTILITY COMPANIES AND USING A SIGNAL LOCATOR PRIOR TO EXCAVATION. ANY AND ALL REPAIRS SHALL BE COMPLETED WITHIN 48 HRS. OR THE OWNER SHALL HAVE THE REPAIR WORK COMPLETED AT THE CONTRACTORS EXPENSE.
3. TOPSOIL AND SEED ALL AREAS DISTURBED AND NOT OTHERWISE DEVELOPED. ALL WORK (IE DEMOLITION AND REMOVALS, DRAINAGE WORK, STONE AND ASPHALT FINISHES, TRACK SURFACE, ETC.) SHALL BE COMPLETED BY DATE AS NOTED IN CONTRACT DOCUMENTS. ALL LAWN AREAS SHALL SLOPE TO DRAINAGE STRUCTURES.
4. ALL CONTOURS AND SPOT GRADES REFER TO FINISH GRADE OF LAWN, ASPHALT, OR CONCRETE. DO NOT FACTOR IN THE ALL-WEATHER SURFACE OR ACRYLIC COATING DEPTH.

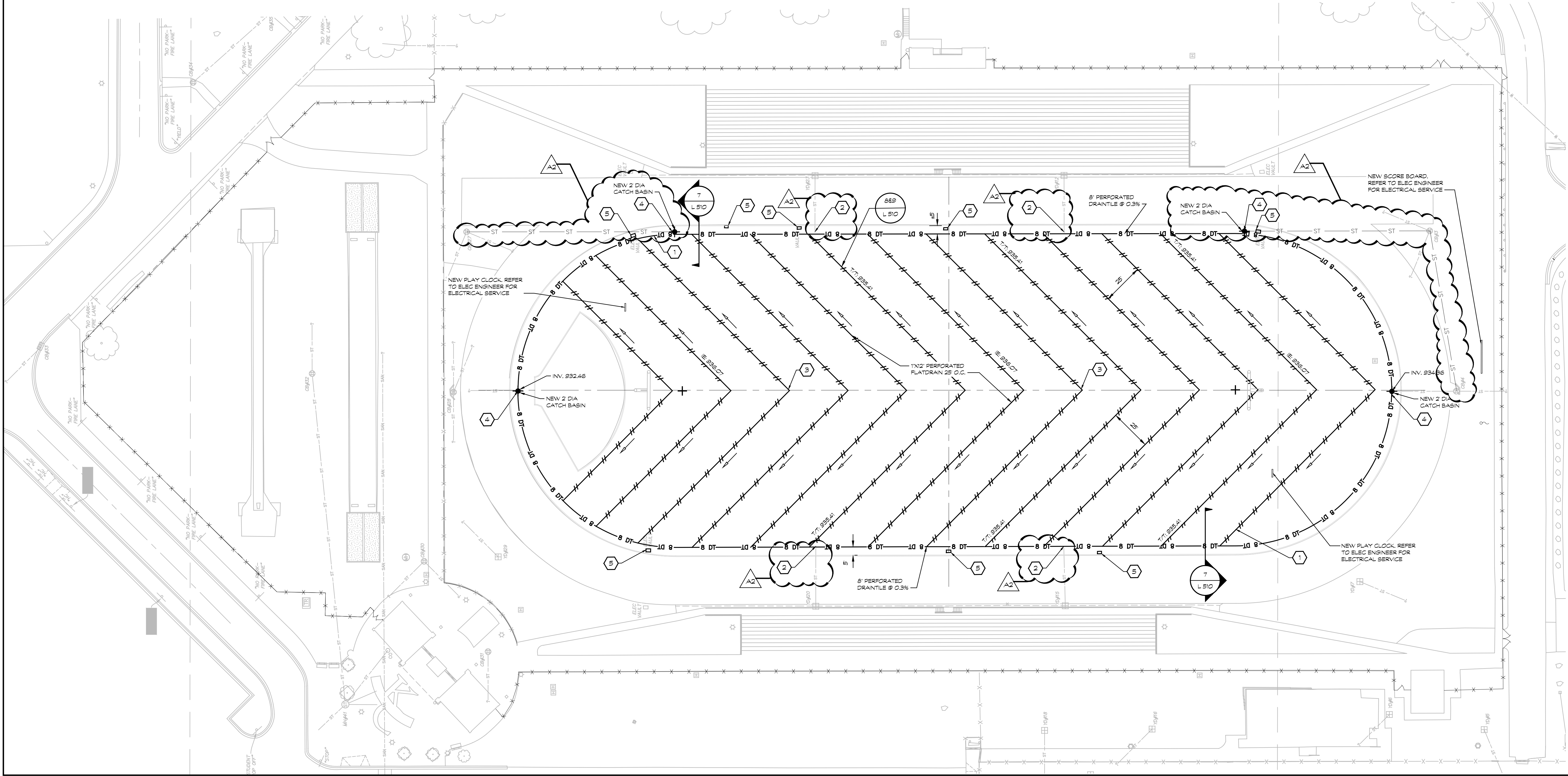
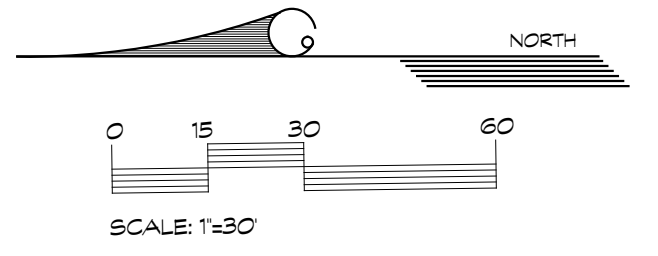

ADDENDUM No. 2 JANUARY 24, 2025  
ADDENDUM No. 1 JANUARY 17, 2025  
ISSUED FOR \_\_\_\_\_ DATE \_\_\_\_\_

PROJECT TITLE  
KALAMAZOO CENTRAL  
HIGH SCHOOL  
ATHLETICS  
PROJECT - BID  
PACKAGE 2

OWNER  
KALAMAZOO PUBLIC  
SCHOOLS  
Kalamazoo, Michigan

SHEET TITLE  
DRAINAGE PLAN  
SHEET NUMBER  
L 505  
23-625.00  
DATE  
DECEMBER 20, 2024